

Frank Harris & Co.



Wesley House, EC1A

£695,000

A beautifully presented, two double bedroom apartment in a Victorian conversion in the heart of the City. There are sash windows throughout, a bathroom, recently fitted modern kitchen with wood counter tops, washing machine and dishwasher. There is built in wardrobe in the principle bedroom and plenty of additional storage in the hallway.

Sandwiched between the St Pauls, St Bartholmews and Smithfield Market Little Britain is in the thick of the City with the restaurants, bars and shops of Moorgate, Liverpool Street and Clerkenwell are all within half a mile.

Frank Harris & Co.

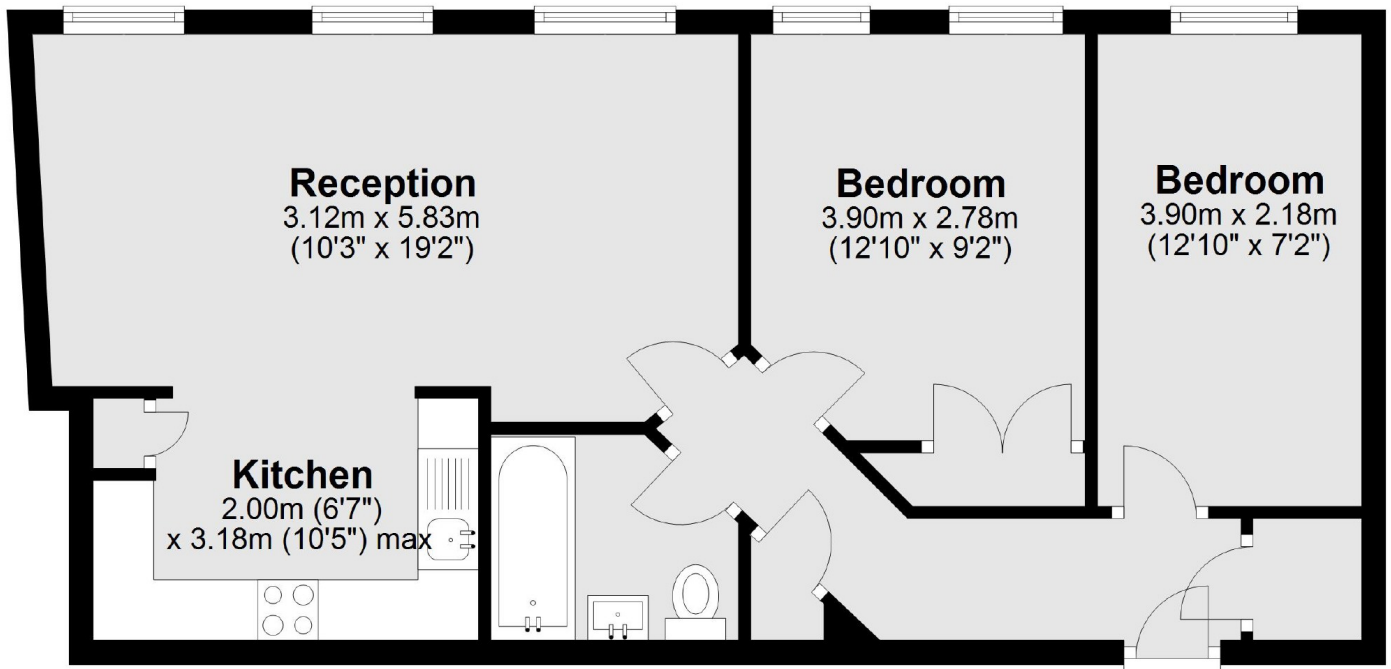

Total area: approx. 53.7 sq. metres (578.0 sq. feet)

Frank Harris & Co. Barbican and City
87 Long Lane, London,
EC1A 9ET
020 7600 7000
citysales@frankharris.co.uk

Energy Rating: C. We aim to make our particulars both accurate and reliable. However they are not guaranteed; nor do they form part of an offer or contract. If you require clarification on any points then please contact us, especially if you're traveling some distance to view. Please note that appliances and heating systems have not been tested and therefore no warranties can be given as to their good working order.

