

Frank Harris & Co.



Cullum Welch House, EC1Y

£375,000

This south facing studio flat is located on the first floor. Beneath the woven rug lies the original parquet floor with the original slate still exposed. The separate kitchen and bathroom has previously been tastefully modernised. With new electric radiators and an updated immersion heater, there is plenty of available storage.

Located within the Grade II Listed Golden Lane estate and close to Barbican station with access to the Elizabeth line.

- Studio Flat • Grade II Listed • South Facing •
- No Onward Chain • On-site Leisure Facilities • Fully Modernised •

Frank Harris & Co.

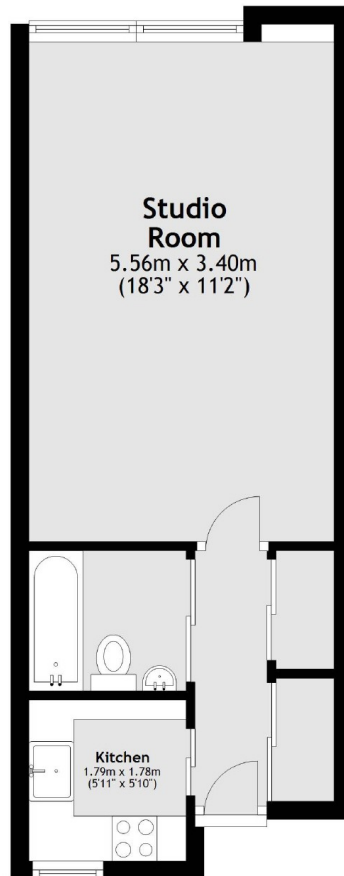

Total area: approx. 30.1 sq. metres (323.5 sq. feet)

Frank Harris & Co. Barbican and City
87 Long Lane, London,
EC1A 9ET
020 7600 7000
citysales@frankharris.co.uk

Energy Rating: . We aim to make our particulars both accurate and reliable. However they are not guaranteed; nor do they form part of an offer or contract. If you require clarification on any points then please contact us, especially if you're traveling some distance to view. Please note that appliances and heating systems have not been tested and therefore no warranties can be given as to their good working order.