



Tresco, Highland Road, Torquay – TQ2 6NH  
£290,000







## Tresco, Highland Road

Torquay, Torquay

Substantial three-bedroom semi-detached family home with sunny garden, driveway and garage, close to excellent schools and Cockington Country Park  
Council Tax band: C

Tenure: Freehold

EPC Energy Efficiency Rating: D

EPC Environmental Impact Rating: D

- Large and well-presented semi-detached family home
- Offered in excellent, move-in-ready condition
- Generous driveway with detached garage
- Southerly-facing rear garden ideal for families and entertaining
- Bay-fronted lounge with feature fireplace
- Modern open-plan kitchen and dining space
- Modern fitted kitchen with Neff ovens, induction hob and integrated dishwasher
- Separate laundry area off the kitchen
- Three well-proportioned bedrooms
- Walking distance to schools, parks, shops and Cockington Country Park





# Tresco, Highland Road

Torquay, Torquay

Highland Road is well positioned within a popular and established residential area of Torquay, valued for its convenience, schooling and access to green space. The property is within easy walking distance of Cockington Country Park, offering extensive parkland, woodland trails and countryside walks, while Armada Park provides further outdoor space close by. Day-to-day amenities are on the doorstep, with a range of local shops and services along Walnut Road and Mill Road catering for everyday needs. The area is particularly well regarded for schooling, with Sherwell Valley Primary School nearby, along with both Torquay Grammar Schools, making the location especially attractive to families. Transport links are excellent. Regular bus services operate close to the property, providing convenient access to Torquay town centre, neighbouring districts and the wider bay. Torquay railway station and Newton Abbot railway station are both easily accessible, offering direct mainline connections to Exeter, Plymouth and London Paddington.

## Absolute Sales & Lettings

Absolute Sales & Lettings Ltd, 13 Ilsham Road - TQ1 2JG

01803 214214

[torquay@movewithabsolute.co.uk](mailto:torquay@movewithabsolute.co.uk)

[movewithabsolute.co.uk/](http://movewithabsolute.co.uk/)





## Ground Floor

Approx. 52.2 sq. metres (561.7 sq. feet)

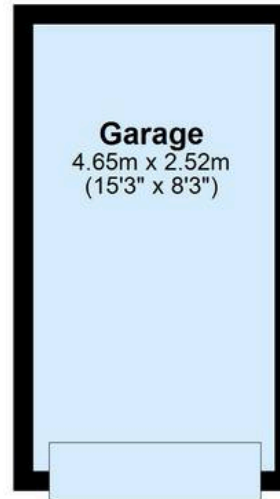

## First Floor

Approx. 41.3 sq. metres (444.8 sq. feet)

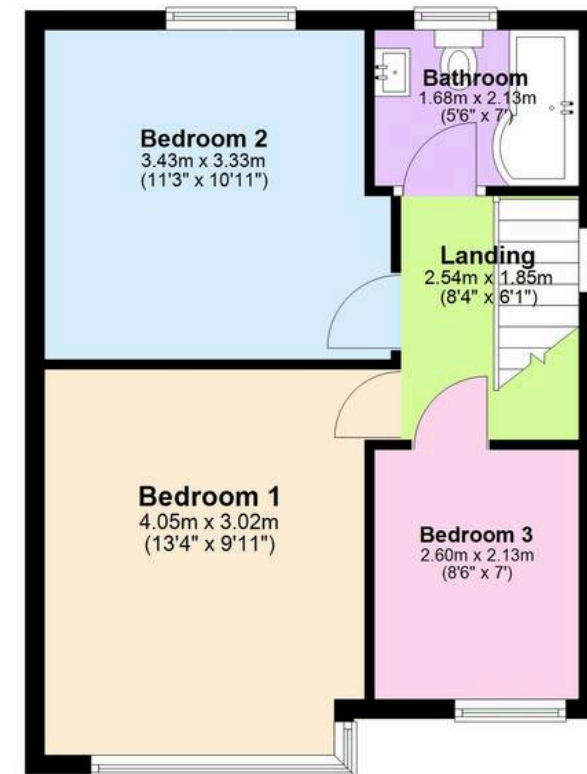

Total area: approx. 93.5 sq. metres (1006.6 sq. feet)