



93 Lyme View Road, Torquay – TQ1 3UF  
£325,000







## 93 Lyme View Road

Torquay, Torquay

Stunning 3-bed detached house in Babbacombe with sea views. Elegant interior, fitted kitchen, balcony, low-maintenance gardens, garage, near amenities. Enjoy luxurious coastal living.

Council Tax band: D

Tenure: Freehold

EPC Energy Efficiency Rating: D

EPC Environmental Impact Rating: E

- A charming red brick detached home in an enviable location enjoying glorious sea views
- Situated in the desirable Babbacombe with dramatic sea views towards Lyme Bay
- A short walk to Cary Park, Babbacombe Downs and St Marychurch
- Ample driveway parking and integral garage
- Easy to maintain front and rear garden with a raised terraced with open sea views
- 3 well sized double bedrooms and a modern shower room upstairs
- Spacious, open and light lounge dining room
- Balcony to the front of the house with elevated sea views across Babbacombe and St Marychurch
- Fitted kitchen with direct garden access





# 93 Lyme View Road

Torquay, Torquay

Lyme View Road enjoys an elevated position atop a winding hill which maximises the stunning coastal views on offer of Babbacombe and Lyme bay in the distance. Close by are the lovely areas of Cary park with its expansive parkland and tree lined streets and the lovely Babbacombe downs with its array of quality restaurants, pubs and offerings. The village of St Marychurch is a short drive which offers an array of local produce and boutiques.

## Absolute Sales & Lettings

Absolute Sales & Lettings Ltd, 13 Ilsham Road - TQ1 2JG

01803 214214

[torquay@movewithabsolute.co.uk](mailto:torquay@movewithabsolute.co.uk)

[movewithabsolute.co.uk/](http://movewithabsolute.co.uk/)



## Ground Floor

Approx. 49.2 sq. metres (529.5 sq. feet)

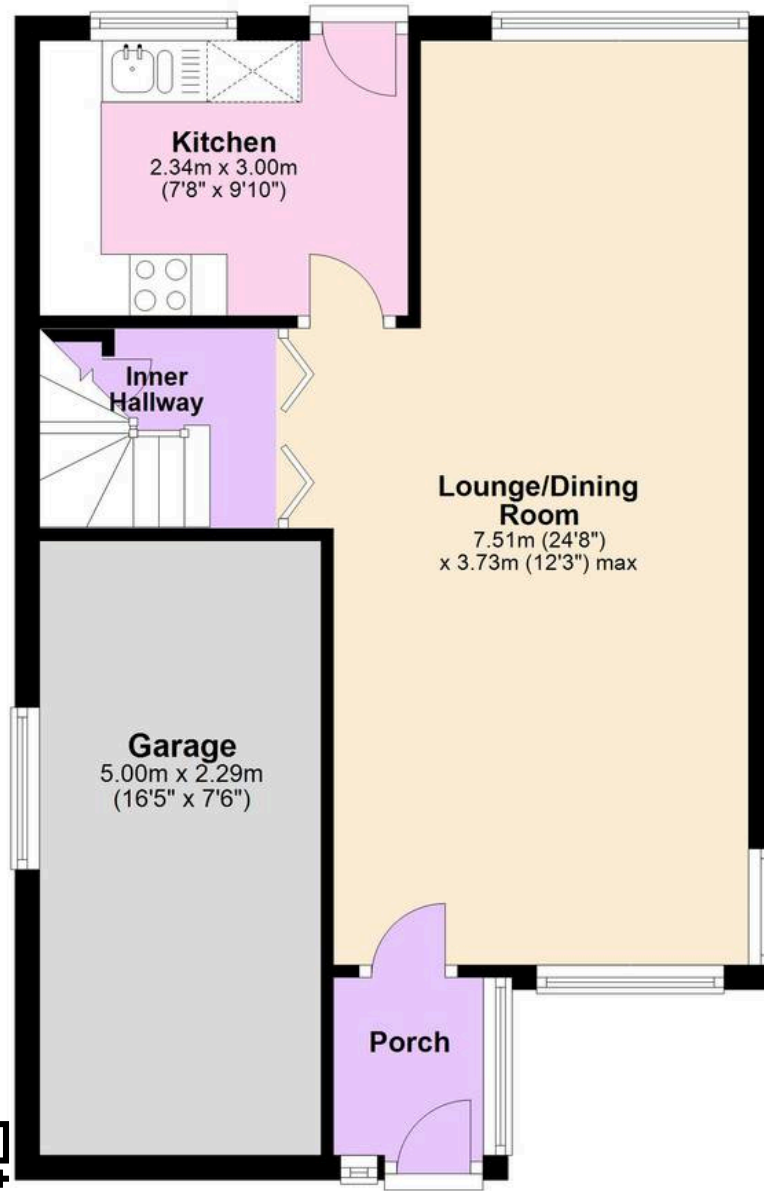

## First Floor

Approx. 43.7 sq. metres (470.5 sq. feet)

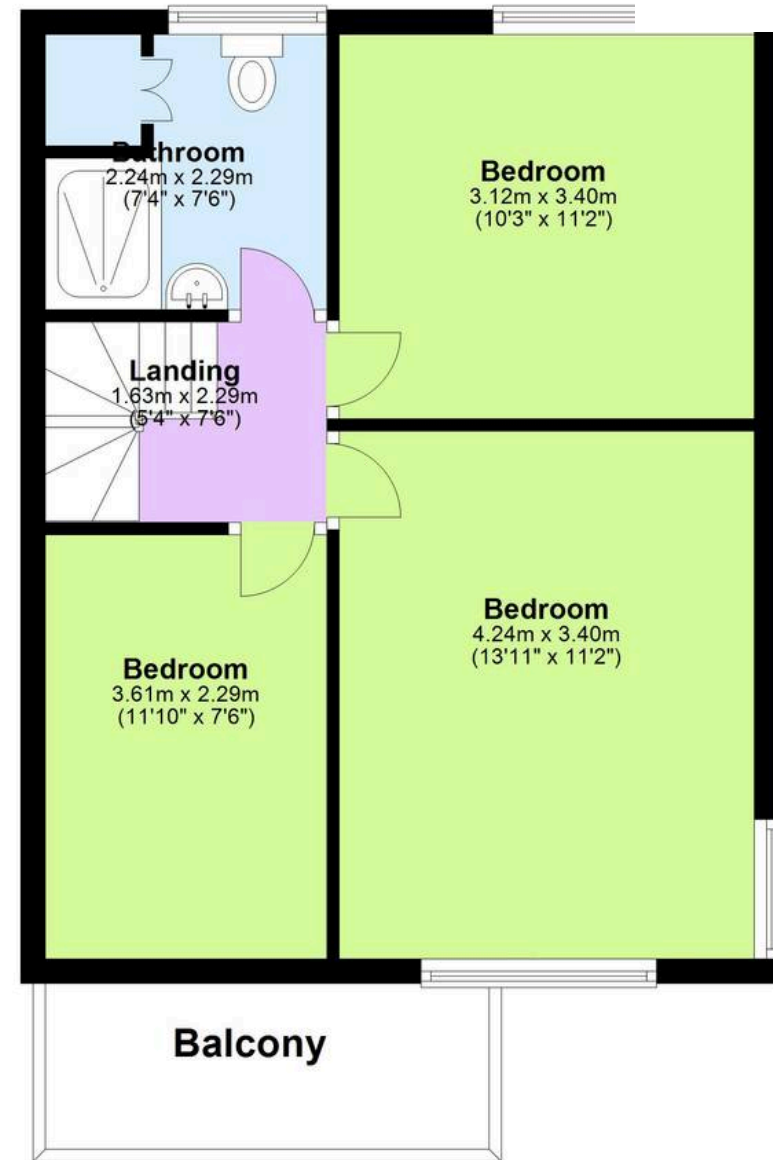

Total area: approx. 92.9 sq. metres (1000.0 sq. feet)

Approx  
Plan produced using PlanUp.

