



17 Wesley Close, Torquay - TQ2 8SH

Guide Price £115,000





## 17 Wesley Close

Torquay, Torquay

Recently redecorated 2 bed first floor flat with new kitchen and carpets. Turnkey ready, private entrance, sitting room, refitted kitchen, 2 beds, bathroom/WC. uPVC double glazing, gas central heating. Communal gardens and parking.

Council Tax band: A

Tenure: Leasehold

EPC Energy Efficiency Rating: C

EPC Environmental Impact Rating: C

- A two bed first floor flat
- Recently fitted kitchen with solid worktops and built in appliances
- Sitting room
- Two bedrooms
- Bathroom/WC
- Gas central heating and uPVC double glazing
- Communal gardens and parking
- Newly decorated with fitted carpets
- No chain
- Ideal first time buyer/investment property



# 17 Wesley Close

Torquay, Torquay

The property occupies a residential position within close proximity to local shops on Barton Hill Road and local schools. Torquay town centre and sea front are both within approximately 3 miles distance. The property is offered with vacant possession and is an ideal first time buyer or investment purchase.

## Absolute Sales & Lettings

Absolute Sales & Lettings Ltd, 13 Ilsham Road - TQ1 2JG

01803 214214

[torquay@movewithabsolute.co.uk](mailto:torquay@movewithabsolute.co.uk)

[movewithabsolute.co.uk/](http://movewithabsolute.co.uk/)



ABS

## First Floor

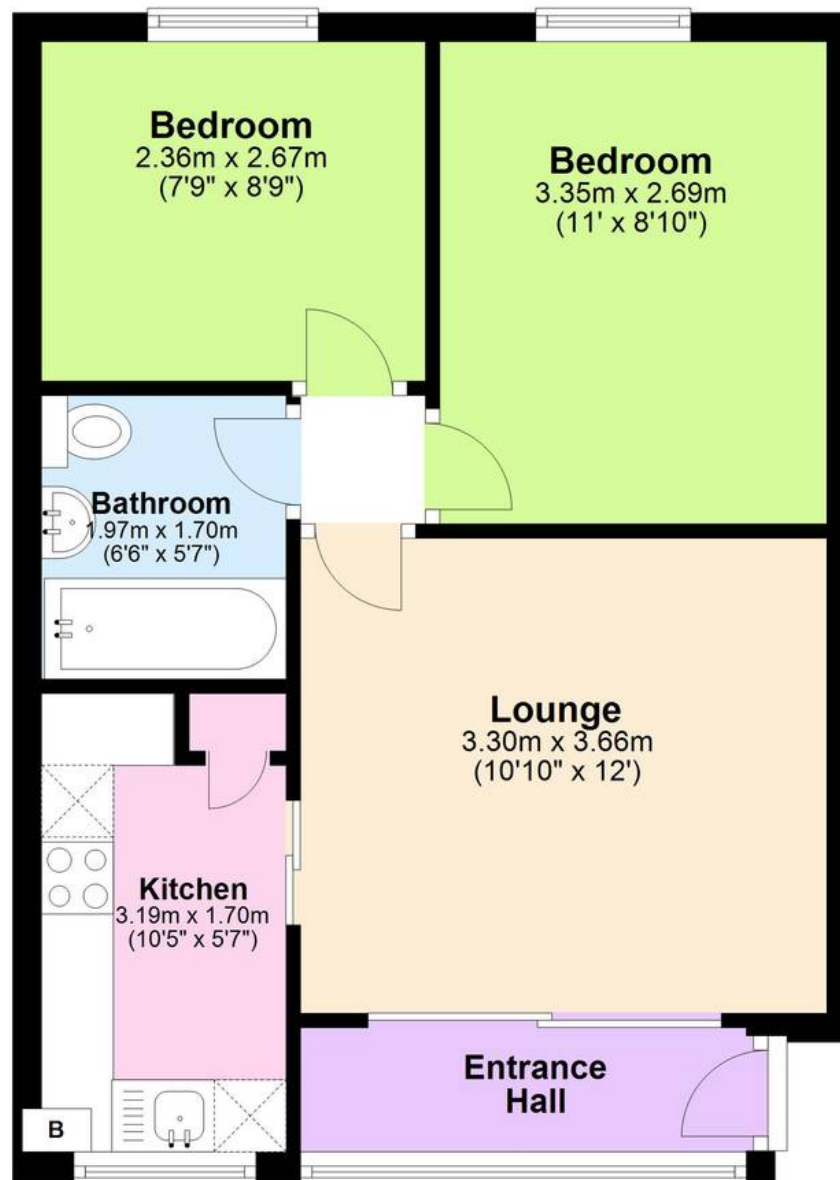

Approx  
Plan produced using PlanUp.

