



ABSOLUTE

## Apartment 3, Shirley Towers, Vane Hill Road, Torquay – TQ1 2BU

Guide Price £440,000





## Apartment 3, Shirley Towers

Vane Hill Road, Torquay

Luxurious first-floor apartment with 3 bedrooms, elegant design, and modern amenities. Spacious lounge, dining area, fitted kitchen, en-suite bedroom, and open air balcony with harbour views. Undercroft parking and convenient location near amenities. Ideal for luxurious living in a vibrant setting.

Council Tax band: F

Tenure: Leasehold

- A spacious three bed first floor apartment
- Spacious open air balcony enjoying views of the harbour bowl and Torre Abbey Sands
- Undercroft parking approached via automated gates
- Three double bedrooms, principal with en suite bathroom/WC
- Lounge and separate dining area
- Cloakroom/WC
- Fitted kitchen with built in appliances
- Family bathroom/WC



# Apartment 3, Shirley Towers

Vane Hill Road, Torquay

The property occupies a sought after residential position elevated above the harbour bowl with stunning views over the surrounding area. Torquay town centre and deep water marina for boating enthusiasts are both within 1/4 of a miles distance. Wellswood Village is within approximately 1 miles distance with its array of boutique shops, facilities and restaurants.

## Absolute Sales & Lettings

Absolute Sales & Lettings Ltd, 13 Ilsham Road - TQ1 2JG

01803 214214

[torquay@movewithabsolute.co.uk](mailto:torquay@movewithabsolute.co.uk)

[movewithabsolute.co.uk/](http://movewithabsolute.co.uk/)



# Floor 1 with private lift access

Approx. 156.8 sq. metres (1687.9 sq. feet)

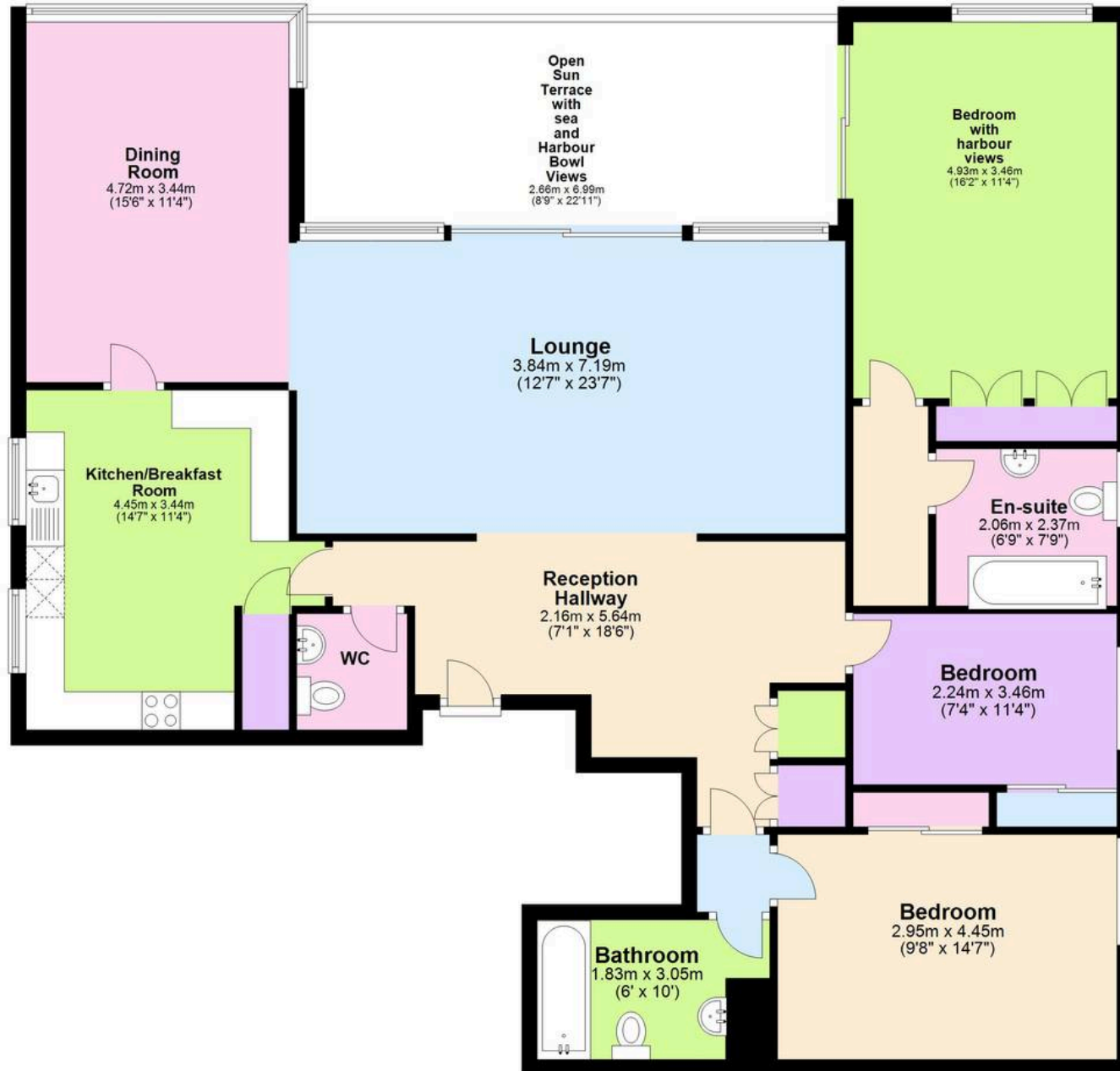

Total area: approx. 156.8 sq. metres (1687.9 sq. feet)

Approx  
Plan produced using PlanUp.

