



Plot 24, Karsbrook Green, Kingskerswell - TQ12 5JS

Guide Price £395,000





Plot 24, Karsbrook Green , Kingskerswell

This modern three-bedroom detached residence in a quiet cul-de-sac offers luxury and comfort. Open living space, underfloor heating, quality kitchen, en suite shower and family bathroom. Tandem driveway, front garden and enclosed rear garden. Ideal for modern living in a desirable setting.

Tenure: Freehold

- A recently constructed three bed detached residence finished to a high specification
- Downstairs cloakroom/WC
- Open plan living space with bi-folding doors
- Quality modern fitted kitchen with solid worktops and integrated appliances
- Three bedrooms, principal having en suite shower room/WC
- Family bathroom/WC
- Under floor heating with engineered oak to the ground floor
- Tandem driveway parking for two cars
- Small front garden and level enclosed rear garden
- Part exchange considered



Plot 24, Karsbrook Green

, Kingskerswell

Nestled within the serene surroundings of Kingskerswell, discover a harmonious blend of traditional charm and contemporary living at Karsbrook Green. Karsbrook Green is close to the neighbouring market town of Newton Abbot and within easy commute of Torbay (Torquay, Paignton, Brixham) and Exeter. Newton Abbot is a historic market town surrounded by beautiful South Devon countryside. The town is home to a large range of shops, restaurants and open spaces and is perfectly located close to both Dartmoor National Park and a wealth of seaside towns. Torbay is a large bay on Devon's south coast, overlooking clear blue waters from their vantage points along the bay are three towns: Paignton, Torquay and Brixham. These hills act as sun-trap, allowing the bay to luxuriate in its own warm microclimate. It is the bays golden sands and rare propensity for fine weather that has led to the bay and its seaside towns being named the English Riviera.

Absolute Sales & Lettings

Absolute Sales & Lettings Ltd, 13 Ilsham Road - TQ1 2JG

01803 214214

torquay@movewithabsolute.co.uk

movewithabsolute.co.uk/

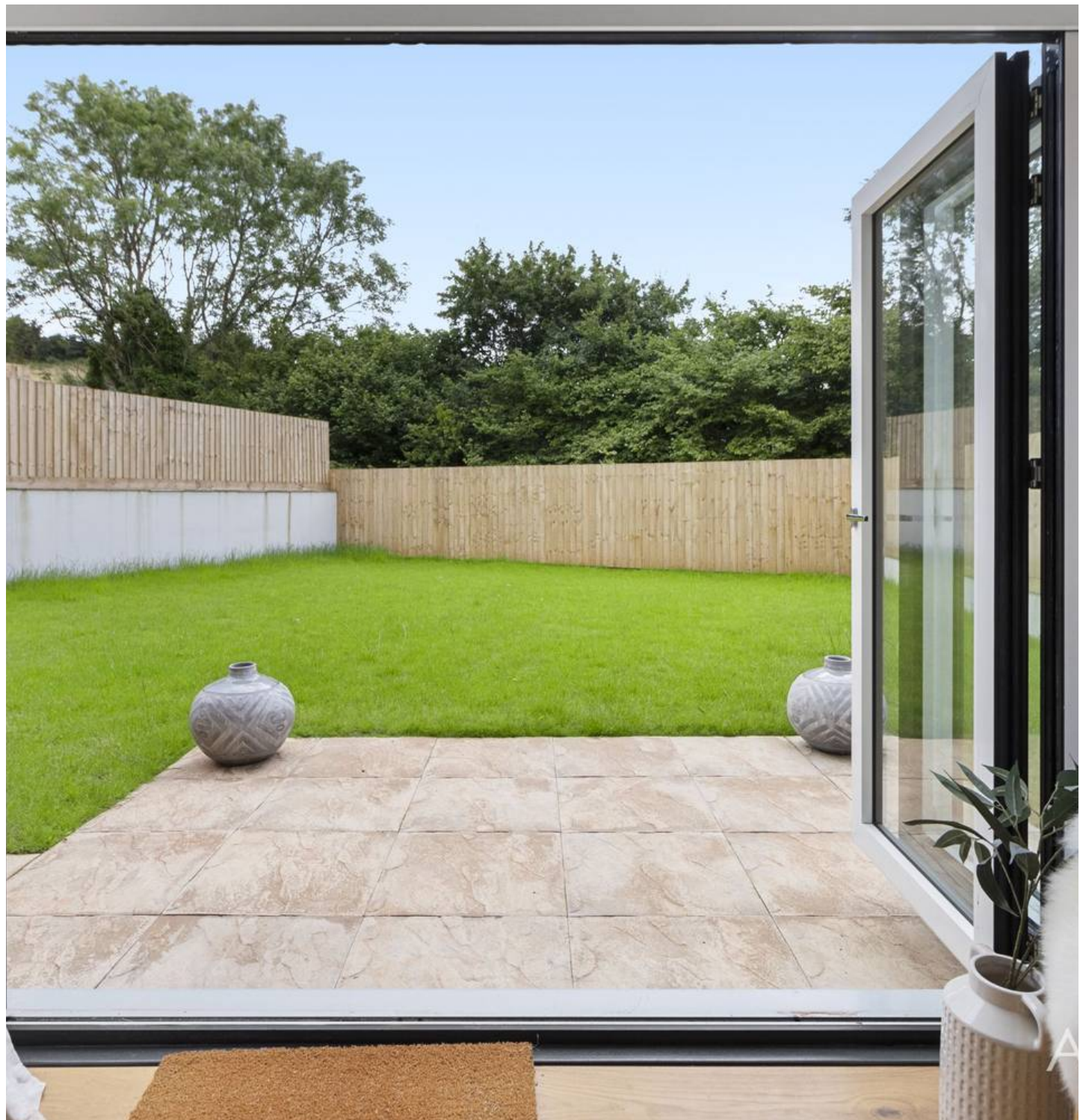

Ground Floor

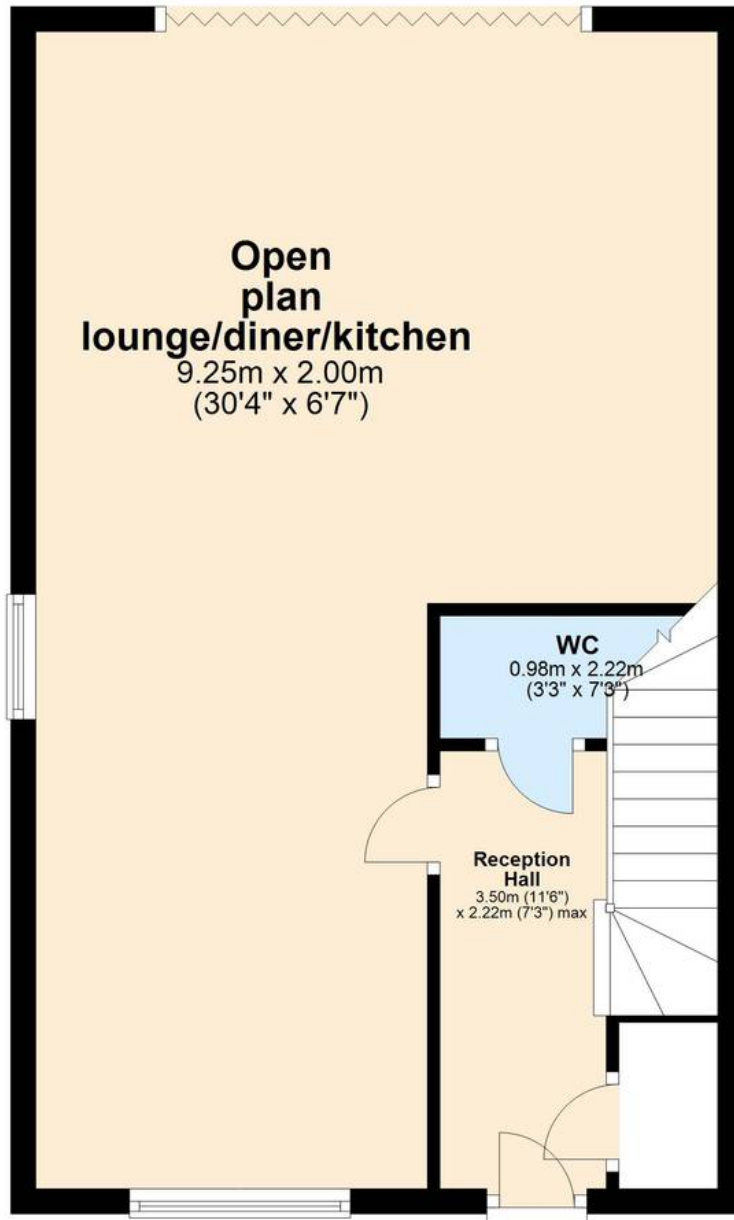

First Floor

