



**58a Ben Jonson Close, Torquay - TQ2 6BT**

Guide Price **£190,000**







## 58a Ben Jonson Close

Torquay

Ideal 3-bed semi house in sought-after area. Lounge/dining room, fitted kitchen, cloakroom/WC. Three bedrooms, bathroom/WC. Front and rear gardens, under-house storage. No chain, ready to move in. Comfortable, convenient living. Great for first-time buyers or investors.

Council Tax band: B

Tenure: Freehold

- Ideal first time buyer or investment property
- Popular residential location
- Useful full height underhouse storage area
- Front and rear gardens
- Well presented 3 bed semi-attached house
- Downstairs cloakroom/WC
- Lounge/dining room
- Fitted kitchen with built in appliances





# 58a Ben Jonson Close

Torquay

The property occupies an end of cul-de-sac popular residential position within close proximity to a local primary school, both Grammar schools and Torbay Hospital with Torquay sea front and town centre both being within approximately 2 miles distance with its array of shops, facilities and amenities. It also offers easy access to the ring road which connects to Newton Abbot, Exeter and beyond.

## Absolute Sales & Lettings

Absolute Sales & Lettings Ltd, 13 Ilsham Road - TQ1 2JG

01803 214214

[torquay@movewithabsolute.co.uk](mailto:torquay@movewithabsolute.co.uk)

[movewithabsolute.co.uk/](http://movewithabsolute.co.uk/)





### Garden Floor

Approx. 13.6 sq. metres (146.0 sq. feet)



### Ground Floor

Approx. 39.8 sq. metres (428.9 sq. feet)

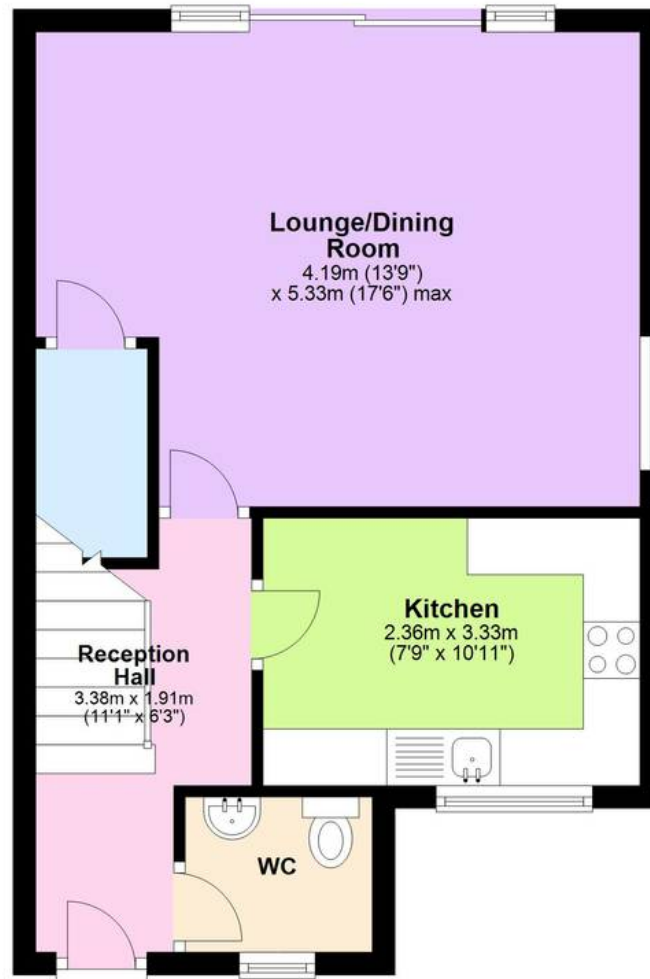

### First Floor

Approx. 36.7 sq. metres (395.0 sq. feet)

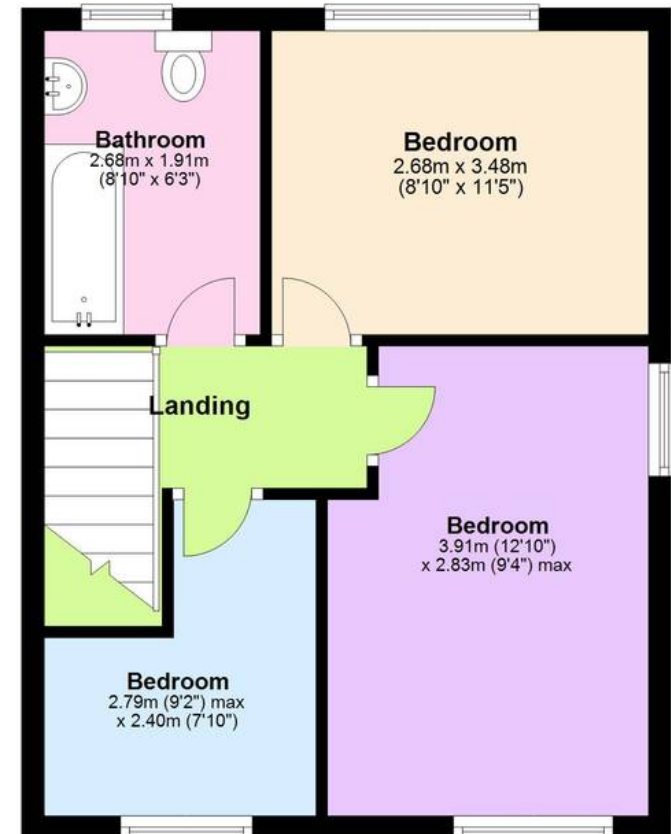

Total area: approx. 90.1 sq. metres (969.9 sq. feet)

Approx  
Plan produced using PlanUp.

