



22 Cormorant Close, Torquay - TQ2 7TH

Guide Price **£219,500**





22 Cormorant Close

Torquay, Torquay

Charming 2-bed terraced house, ideal for first-time buyers or investors. Features sitting room, fitted kitchen/dining room, en suite to principal bedroom, gas heating, double glazing, driveway parking, garage. Enclosed rear gardens. Convenient location with local amenities. Stylish practical living.

Council Tax band: C

Tenure: Freehold

EPC Energy Efficiency Rating: C

EPC Environmental Impact Rating: C

- Ideal first time buyer or investment property
- Offered with vacant possession
- Sitting room
- Fitted kitchen/dining room with built in appliances
- Two bedrooms, principal with en suite shower room/WC
- Family bathroom/WC
- Gas central heating and uPVC double glazing
- Driveway parking
- Single garage in a nearby block
- Enclosed rear gardens



22 Cormorant Close

Torquay, Torquay

The property occupies a popular residential position within the Willows area of Torquay being within close proximity to Wren Retail Park, both Grammar schools and Torbay Hospital. There is easy access to the bypass which connects to Newton Abbot, Exeter and beyond with Torquay town centre and sea front both being approximately 3 miles distance.



Absolute Sales & Lettings

Absolute Sales & Lettings Ltd, 13 Ilsham Road - TQ1 2JG

01803 214214

torquay@movewithabsolute.co.uk

movewithabsolute.co.uk/



Ground Floor

Approx. 43.6 sq. metres (468.9 sq. feet)

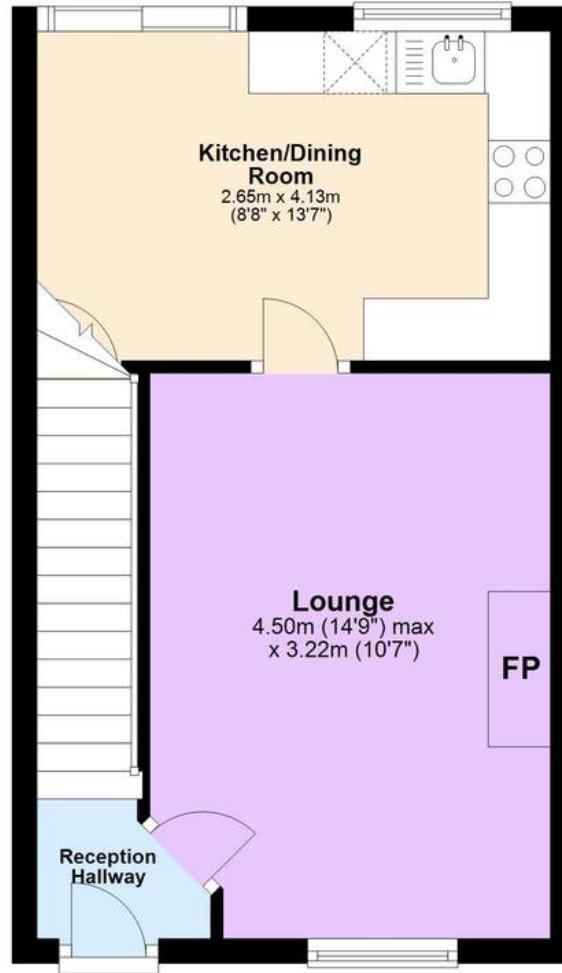
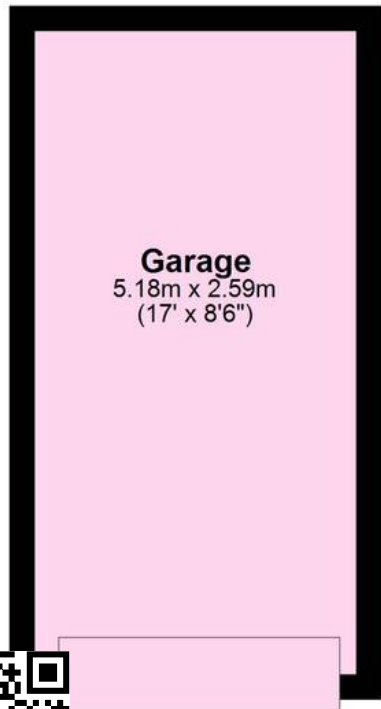

First Floor

Approx. 30.5 sq. metres (328.0 sq. feet)

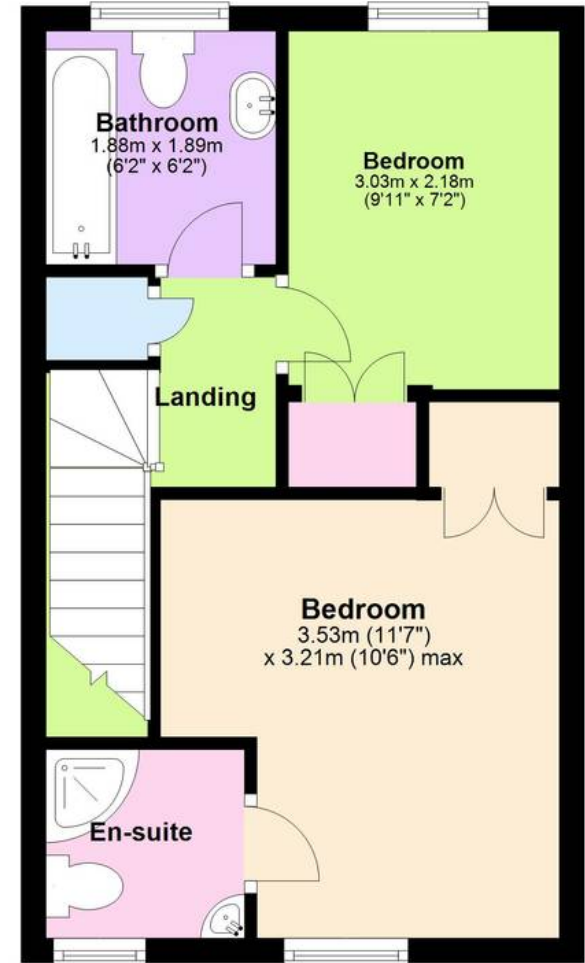

Total area: approx. 74.0 sq. metres (797.0 sq. feet)

Approx
Plan produced using PlanUp.

