





47a Chatto Road

Torquay, Torquay

Nestled in a tranquil residential area, this exquisite four-bedroom detached dormer bungalow offers an idyllic blend of contemporary living and homely comfort. With a charming façade and elegant design, this property exudes a welcoming ambience from the moment you arrive.

Upon entering, you are greeted by a spacious sitting room that boasts an abundance of natural light, creating a warm and inviting atmosphere. The heart of the home lies in the well-appointed fitted kitchen/dining room, ideal for entertaining guests or enjoying family meals. The adjacent conservatory further enhances the living space, providing a peaceful retreat to relax and unwind.

The accommodation is thoughtfully laid out, with two generously proportioned bedrooms situated on the ground floor, offering convenience and flexibility for multigenerational living or hosting guests. A contemporary bathroom/WC completes the ground floor layout, providing modern amenities and functionality.



Ascending the stairs, you will find two additional tastefully decorated bedrooms on the first floor, each offering a private sanctuary away from the hustle and bustle of daily life. The versatility of the property's design allows for various lifestyle preferences and room functionality to suit individual needs.

Externally, the property features driveway parking for multiple vehicles, as well as a single garage providing secure storage space or parking. Surrounding the property, gardens to the side and rear create a tranquil outdoor space, perfect for enjoying al fresco dining or simply basking in the serenity of the surroundings.

Conveniently located within easy reach of local amenities, schools, and transport links, this property offers a harmonious balance of seclusion and accessibility. Whether relaxing in the comfort of your home or exploring the nearby attractions, this property presents an opportunity to embrace a lifestyle of modern convenience and peaceful living.

In summary, this four-bedroom dormer bungalow is a rare find, showcasing a seamless fusion of style, comfort, and functionality. With its versatile layout, high-quality finishes, and desirable location, this property presents a unique opportunity to own a home that encompasses the essence of contemporary living.

Garden

At the front of the property a path gives access down both sides of the property with one side having a level lawned garden and artificial grass to the rear. The garden is enclosed by brick walling.



47a Chatto Road

Torquay, Torquay

The property occupies a popular residential position nestled between Plainmoor and St Marychurch within close proximity to excellent local schools, plus an array of shops and supermarkets. Chatto Road is set approximately 3/4 of a mile from the lively Torquay town centre, sea front and deep water marina, which boast an enviable selection of restaurants, cafes, shops and further amenities. There is easy access to both Grammar schools, Torbay Hospital and the ring road which connects to Newton Abbot, Exeter and beyond.

Council Tax band: C

Tenure: Freehold

EPC Energy Efficiency Rating: D

Driveway

The property is approached via a concrete driveway allowing for ample off road parking for up to 2 cars

Garage

The driveway leads to the single garage with up and over door, light and power.





ABSOLUTE



Ground Floor

Approx. 76.7 sq. metres (825.5 sq. feet)



First Floor

Approx. 30.4 sq. metres (326.8 sq. feet)

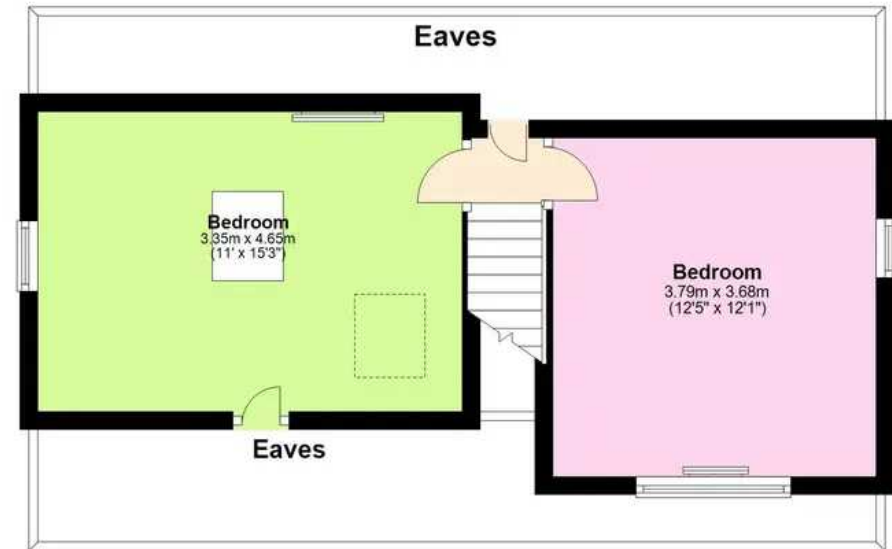

Total area: approx. 131.3 sq. metres (1413.0 sq. feet)

Approx
 Plan produced using PlanUp.





Absolute Sales & Lettings

Absolute Sales & Lettings Ltd, 13 Ilsham Road - TQ1 2JG

01803 214214

torquay@movewithabsolute.co.uk

movewithabsolute.co.uk/

