



Leytonstone Road, London, E15 1SQ £1,100 Per Calendar Month

 0  1  1  E

****SPACIOUS STUDIO FLAT WITHIN A HOUSE CONVERSION, SITUATED IN A PRIME LOCATION CLOSE TO MARYLAND STATION (ELIZABETH LINE)****

OC Homes would like to offer this well-presented studio flat, situated on the first floor, of a period conversion. The property boasts a spacious open-plan living area with a fitted kitchen, in addition to a three-piece bathroom suite.

The studio flat is situated in a great location, with easy access to local amenities and public transport links.

AVAILABLE NOW!

Viewing

Please contact our OC Homes Leyton Office on 02085561212 if you wish to arrange a viewing appointment for this property or require further information.





Leytonstone Road Stratford, E15

GROSS INTERNAL AREA
27.1 sq m / 291 sq ft

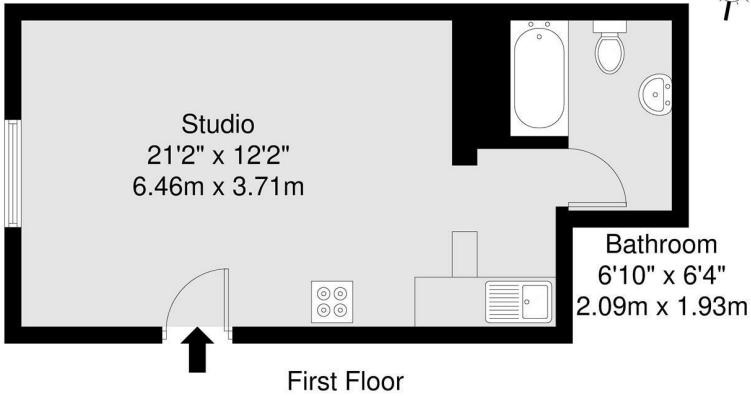

GROSS INTERNAL AREA (GIA)
The largest of any room (not 1910)

TOTAL STORAGE SPACE
Including wardrobes, cupboards, etc.

EXTERNAL STRUCTURAL FEATURES
Including balconies, terraces, etc.

RESTRICTED HEAD HEIGHT
Including porches, etc.

Disclaimer: Floorplan measurements are approximate and are for illustrative purposes only. While we do not doubt the floorplan accuracy and completeness, you or your advisors should conduct a careful, independent investigation of the property in respect of monetary valuation.

Maison VUE

Energy Efficiency Rating

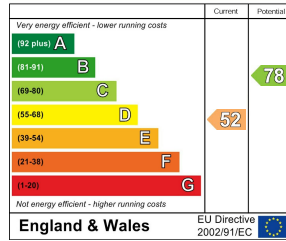

Environmental Impact (CO₂) Rating

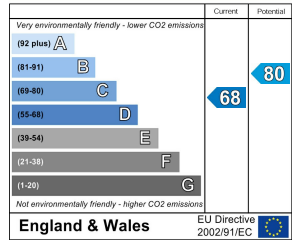

These particulars, whilst believed to be accurate are set out as a general outline only for guidance and do not constitute any part of an offer or contract. Intending purchasers should not rely on them as statements of representation of fact, but must satisfy themselves by inspection or otherwise as to their accuracy. No person in this firm's employment has the authority to make or give any representation or warranty in respect of the property.



320 High Road Leyton, Leyton, London, E10 5PW
t. 02085561212 | e. hello@ochomes.co.uk
w. oneclickhomes.co.uk