

Thetford, Norfolk, IP24



£225,000



This brand new, modern-furnished Prestige Burleigh luxury park bungalow (40'x20') is perfect for those looking for a detached, easy to maintain, bungalow-style retirement property. The landscaped exterior boasts large windows, a garden area and a parking space. The home has a spacious, open plan kitchen and dining space, a comfortable living room, two bedrooms and two bathrooms.

The park has beautifully landscaped grounds, and it is ideal for making the most of wonderful walking trails as well as local amenities. This stunning new residential development is located near Great Hockham, a highly sought-after village in Norfolk. This location offers residents the opportunity to enjoy a quintessentially English lifestyle with access to local amenities, walks and culture.

Age restriction: Over 45s

Pet friendly: Yes

Site fees: £245.23 per month

Residential license

House to sell?

Hassle-free Property Part-Exchange is available from Quickmove Properties, with no estate agent fees, no solicitor's fees and no market uncertainty.

Key Features

- 10-Year Goldshield Warranty
- Brand new home
- Part exchange available
- Fully Furnished
- Gated and secure community
- Outstanding Location
- Pet-Friendly
- Popular residential development
- Stamp Duty Exempt
- Over 45s

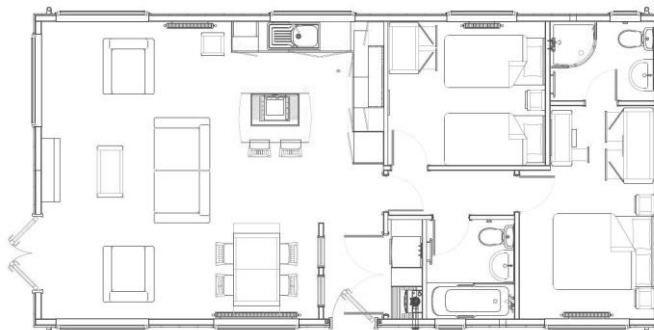

CONTACT US

01793 840917

advice@quickmoveproperties.co.uk

Quickmove
PROPERTIES



The Property
Ombudsman