

# Chelmsford, Essex, CM2



Price as listed





This pre-owned Homeseeker Langdale (40'x10') park home is perfect for those looking for a detached, easy-to-maintain, bungalow-style property. The home has an open plan kitchen, dining and living room, one double bedroom, a study and a bathroom. The home has an allocated parking space and a private, low maintenance garden with a 6'x4' shed.

The park is within easy reach of Chelmsford and the excellent commuter service into London. It combines the convenience of accessibility to the city with the pleasures of living in the heart of the picturesque Essex countryside. Shopping facilities are more than adequate together with a Doctor, Library and Dentist all within a 5 mile radius. Local sporting facilities include golf and swimming.

Age restriction: Over 40s

Pet friendly: 1 Cat Only

Site fees (at time of listing): £252.08 per month

Residential license

### House to sell?

Hassle-free Property Part-Exchange is available from Quickmove Properties, with no estate agent fees, no solicitor's fees and no market uncertainty.

### Key Features

- Communal lawn
- Garden Shed
- Private garden space
- Over 40's
- Part Exchange Available
- Residential Development
- Study
- Well maintained home

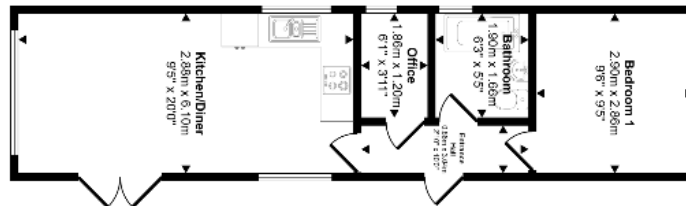

### CONTACT US

01793 840917

[advice@quickmoveproperties.co.uk](mailto:advice@quickmoveproperties.co.uk)

**Quickmove**  
PROPERTIES

