

# Bodmin, Cornwall, PL31



Price as listed



This pre-owned Omar (26'x15') park home is perfect for those looking for a detached, easy-to-maintain, bungalow-style property. The home is vacant and unfurnished, with a kitchen, a living room with a fireplace, two bedrooms and a bathroom. The home has a private garden area with views overlooking the countryside.

The park is well situated with local pubs and restaurants within walking distance and a bus stop outside the park entrance. The historical town of Bodmin offers a range of amenities including local shops, supermarkets, a train station and a hospital. Local attractions include Bodmin Jail, Lanhydrock Hotel and Golf Club, Goss Moor National Nature Reserve and the Eden Project, all less than 10 miles away.

Age restriction: Over 50s

Pet friendly: No

Site fees (at time of listing): £290 per month

Residential license

## Key Features

- Driveway
- Great views
- Garden space
- Over 50's
- Established Development
- Pre-owned park home
- Residential Development
- Community living
- Two bedrooms
- Vacant home

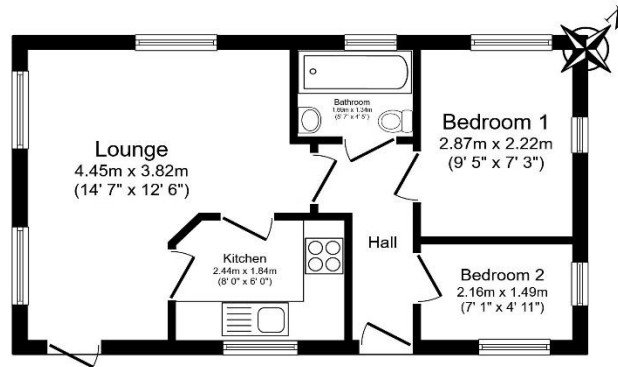

Total floor area 35.3 sq.m. (380 sq.ft.) approx

This floor plan is for illustrative purposes only. It is not drawn to scale. Any measurements, floor areas (including any total floor area), openings and orientation are approximate. No details are guaranteed, they cannot be relied upon for any purpose and they do not form part of any agreement. No liability is taken for any error, omission or misstatement. A party must rely upon its own inspection(s). Powered by [www.bodasagent.com](http://www.bodasagent.com)



## House to sell?

Hassle-free Property Part-Exchange is available from Quickmove Properties, with no estate agent fees, no solicitor's fees and no market uncertainty.

## CONTACT US

01793 840917

[advice@quickmoveproperties.co.uk](mailto:advice@quickmoveproperties.co.uk)

**Quickmove**  
PROPERTIES



The Property  
Ombudsman