

Frenchay, Bristol, BS16



Price as listed



This brand-new, modern-furnished Willerby Kingswood (40'x20') luxury park home is perfect for those looking for a detached, easy-to-maintain, bungalow-style property. The home has a modern kitchen with integrated appliances, a dining area and a comfortable living room. There are two double bedrooms, an en suite and a main bathroom.

This residential development is exclusive for those over 45s. It offers community living for like-minded people in a woodland setting close to the River Frome. The park is pet-friendly. Access to the park is via a splayed entrance drive leading to tarmac surfaced site roads. Local facilities can be found in Fishponds and Downend, whilst more comprehensive amenities can be obtained in Bristol centre itself.

Age restriction: Over 45s
 Pet friendly: Yes (2 per home)
 Site fees: £247.43 per month
 Residential license

House to sell?

Hassle-free Property Part-Exchange is available from Quickmove Properties, with no estate agent fees, no solicitor's fees and no market uncertainty.

Key Features

- Community Living
- Exceptionally High Specification
- Fully Furnished
- Part Exchange Available
- Pet-Friendly
- Residential Development
- Shops and amenities nearby
- Two Bedrooms
- Woodland Setting

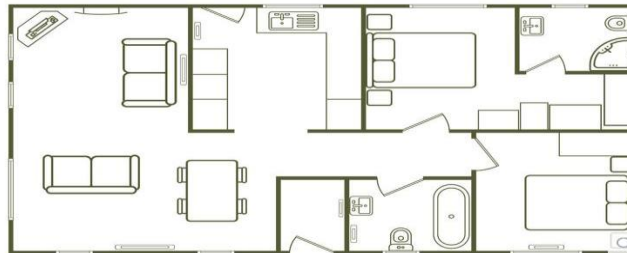

CONTACT US

01793 840917

advice@quickmoveproperties.co.uk

Quickmove
 PROPERTIES

