

Bordon, Hampshire, GU35

Quickmove
PROPERTIES



£270,000

 x 2

 x 2

This pre-owned, well maintained Omar Regency park home (45'x20') is perfect for those looking for a detached, easy to maintain, bungalow-style retirement property. The home has a spacious kitchen, dining area, comfortable living room with an electric fireplace, and a conservatory leading out to the raised decking. There are two double bedrooms, one with an en suite, and there is a further family bathroom.

The park is surrounded by stunning countryside in a beautiful corner of East Hampshire. While the setting is secluded and peaceful, you're also close to the hustle and bustle of larger towns such as Alton, Fareham, Haslemere, Guildford and the charming market town of Petersfield. The development is also just minutes away by car from Whitehill Forest shopping centre.

Age restriction: Over 45's
 Site fees: £283.15 per month
 Pet friendly: Yes
 Residential licence

Key Features

- Decking
- Garden space
- Over 45s
- Part Exchange Available
- Pet-Friendly
- Pre-owned park home
- Private, Gated Development
- Residential Development
- Two Double Bedrooms

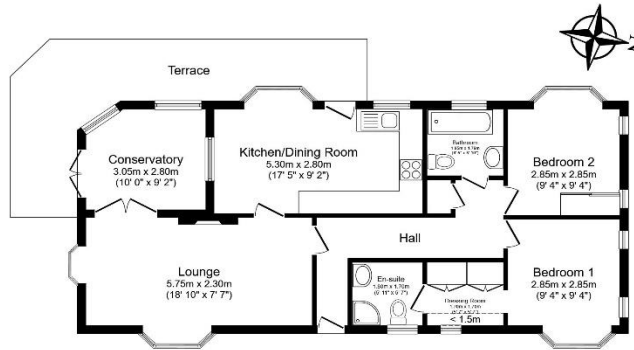

Total floor area 80.9 sq.m. (871 sq.ft.) approx
 Restricted height 0.7 sq.m. (7 sq.ft.)
This floor plan is for illustrative purposes only. It is not drawn to scale. Any measurements, floor areas (including any total floor area), openings and orientation are approximate. No details are guaranteed, they cannot be relied upon for any purpose and they do not form part of any agreement. No liability is taken for any error, omission or misstatement. A party must rely upon its own inspection(s). Powered by www.houseagent.com



House to sell?
 Hassle-free Property Part-Exchange is available from Quickmove Properties, with no estate agent fees, no solicitor's fees and no market uncertainty.

CONTACT US
 01793 840917
 advice@quickmoveproperties.co.uk

