

Worcester, Worcestershire, WR2



£95,000



This pre-owned Stately (36'x12') park home is perfect for those looking for a detached, easy-to-maintain, bungalow-style property. The home has a living room, kitchen, one double bedroom and a bathroom with a walk-in shower.

This established residential development is located in a village setting providing its residents with a peaceful atmosphere while being close to city amenities. The development is located near a few small villages including Callows End and Powick, which are a short drive from the city of Worcester. Worcester is a lovely small city on the River Severn, with a bustling town centre. The Malvern Hills is a short drive from the park with stunning scenery and walking routes.

Age restriction: Over 52

Pet friendly: Yes

Site fees: £160 every 4 weeks

Residential license

House to sell?

Hassle-free Property Part-Exchange is available from Quickmove Properties, with no estate agent fees, no solicitor's fees and no market uncertainty.

Key Features

- Community Living
- One Double Bedroom
- Over 52
- Parking space
- Part Exchange Available
- Pre-owned park home
- Residential Development
- Pet friendly
- View Now
- Vacant home

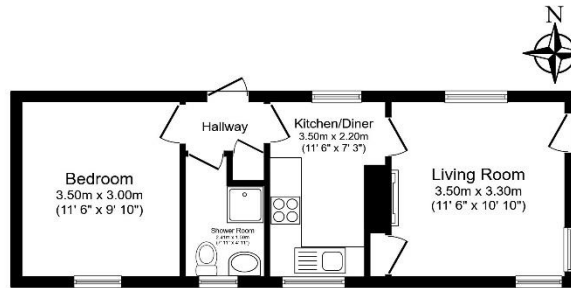

Total floor area 36.0 sq.m. (388 sq.ft.) approx.
 This floor plan is for illustrative purposes only. It is not drawn to scale. Any measurements, floor areas (including any floor area), openings and orientation are approximate. No details are guaranteed. They cannot be relied upon for any purpose and they do not form part of any agreement. No liability is taken for any error, omission or misstatement. All prices must only apply to our independent. Owned by www.localpart.com



CONTACT US

01793 840917

advice@quickmoveproperties.co.uk

