

# Ashford, Kent, TN26

**Quickmove**  
PROPERTIES



£139,995

 x 2

 x 1

This brand new, modern-furnished Omar Newmarket (40'x12') luxury park home is perfect for those looking for a detached, easy to maintain, bungalow-style property. The home has a kitchen with integrated appliances, a comfortable living area, two bedrooms and a bathroom.

This Park is set in rolling countryside, with the added benefit of superb fishing ponds, acres of open walking fields and a designated relaxation area for residents. Less than a mile away in Woodchurch village, which has all the local amenities including a post office, farm shop, small general store, garage and a doctor's surgery. Ashford is not far away and there is a bus stop at the entrance to the park making it convenient to travel to local villages and markets.

Age restriction: Over 50s

Pet friendly: Yes

Site fees (at time of listing): £286 per month

Residential license

### House to sell?

Hassle-free Property Part-Exchange is available from Quickmove Properties, with no estate agent fees, no solicitor's fees and no market uncertainty.

### Key Features

- Brand new home
- Established Park
- Fully Furnished
- Integrated Appliances
- Over 50s
- Part Exchange Available
- Pet-Friendly
- Priced for a quick sale
- Residential

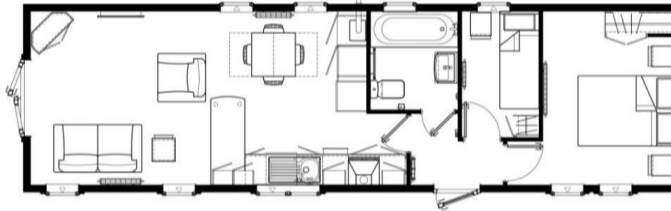

## CONTACT US

01793 840917

[advice@quickmoveproperties.co.uk](mailto:advice@quickmoveproperties.co.uk)

**Quickmove**  
PROPERTIES

