

Exeter, Devon, EX6

Quickmove
PROPERTIES



Price as listed

 x 2  x 2

This brand new, modern-furnished Pathfinder Springfield luxury park home (38x20) is perfect for those looking for a detached, easy to maintain, bungalow style property. The home is ready to occupy and is fully furnished.

The park is situated at the very edge of Dartmoor National Park. 30 minutes away are the beaches of the English Riviera and the Jurassic Coast, Exmouth, Budleigh Salterton, Sidmouth, Seaton, Beer, Lyme Regis and many others. The North Atlantic coast with its sandy beaches is only an hour away. Tedburn St Mary and Cheriton Bishop are only two minutes away in opposite directions, offering village stores and old-fashioned pubs serving excellent food.

Age restriction: None

Pet friendly: Yes

Site fees: £3400 per year

12-month leisure license

Key Features

- 12 month leisure licence
- Brand new
- Fully furnished
- Garden
- Gated and secure
- No age restrictions
- Outdoor pool
- Outstanding location
- Parking
- Pet friendly

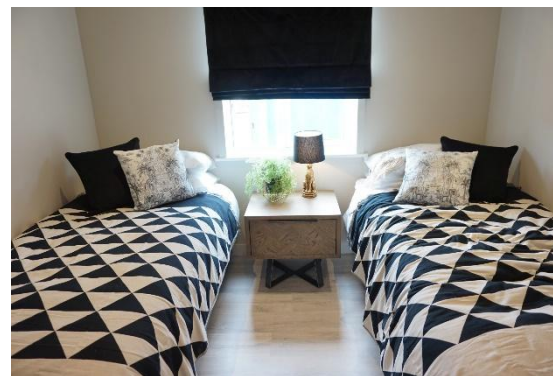
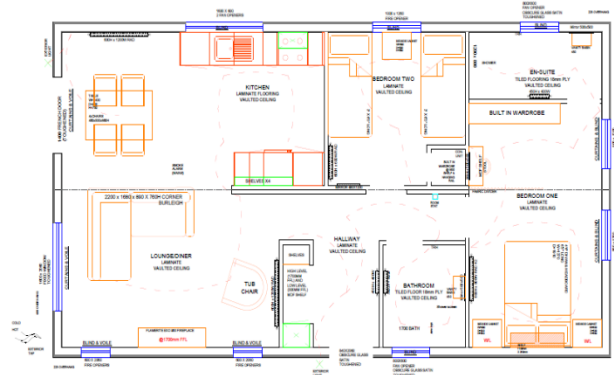

House to sell?

Hassle-free Property Part-Exchange is available from Quickmove Properties, with no estate agent fees, no solicitor's fees and no market uncertainty.

CONTACT US

01793 840917

advice@quickmoveproperties.co.uk

Quickmove
PROPERTIES

