



21 HOME GROUND,
SHIREHAMPTON, BS11 0HN

**GOODMAN
& LILLEY**



TUCKED AWAY IN THE CHARMING HOME GROUND ESTATE IN SHIREHAMPTON, THIS DELIGHTFUL 3-BEDROOM END TERRACE HOUSE IS A TRUE GEM WAITING TO BE DISCOVERED. SITUATED IN A CUL DE SAC ON A HUGELY POPULAR ROAD, THIS PROPERTY OFFERS NOT JUST A HOME, BUT A LIFESTYLE.

Kitchen

uPVC double glazed window to front aspect, composite entrance door, a mixture of eye level and low level storage cupboards with roll top work surfaces, electric hob with extractor fan over, raised oven and microwave, built in fridge/freezer. stainless steel sink with mixer tap over, combi boiler, radiator.

Lounge

uPVC double glazed window to front aspect, radiator

Dining Room

uPVC double glazed window and patio doors to rear aspect, space for large dining table, radiator

Landing

Doors to all first floor rooms, radiator, loft hatch

Bedroom 1

uPVC double glazed window to front aspect, radiator

Bedroom 2

uPVC double glazed window to rear aspect, radiator

Bedroom 3

uPVC double glazed window to front aspect, radiator

Bathroom

uPVC double glazed window to rear aspect, low level toilet with push button flush, panel bath with shower screen and shower over, heated towel rail, storage cupboard

Front of Property

The property offers two parking spaces to the front aspect and gated side access leading to the garden.

Rear of Property

The rear garden is mainly laid to lawn with a patio area and a shed placed at the end of the garden.

-
- Peaceful cul de sac location
 - Open plan entertaining space
 - Village location
 - 2 Off street parking spaces
 - 3 favorable sized bedrooms
 - Westerly facing sunny garden
 - Close to the woodland walks of Kings Weston house
 - End of Terrace



£365,000



Ground Floor

Approx. 79.7 sq. metres (857.9 sq. feet)

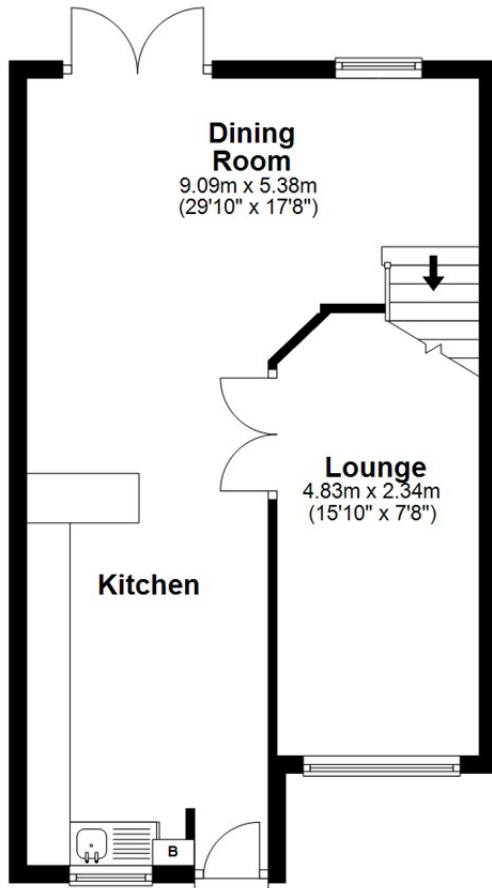

First Floor

Approx. 46.0 sq. metres (495.1 sq. feet)

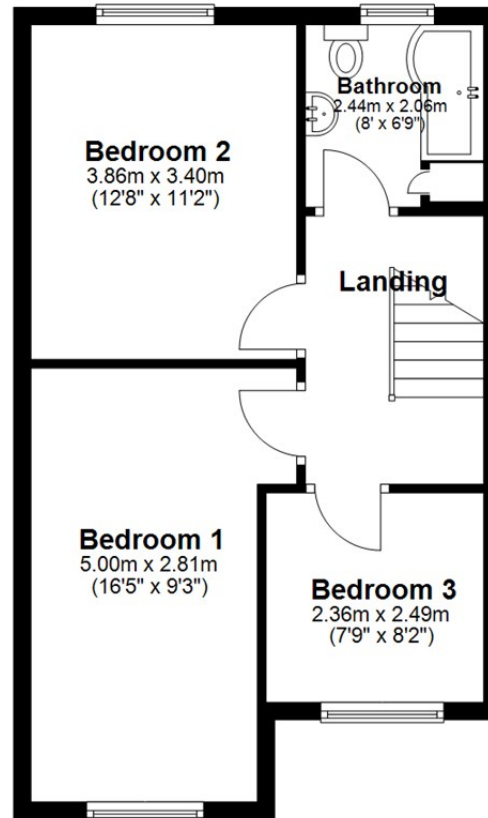

Total area: approx. 125.7 sq. metres (1353.0 sq. feet)

HENLEAZE - 0117 2130777
henleaze@goodmanlilley.co.uk

PORTISHEAD - 01275 430440
sales@goodmanlilley.co.uk

SHIREHAMPTON - 0117 2130333
shire@goodmanlilley.co.uk

Zoopla.co.uk

rightmove



WWW.GOODMANLILLEY.CO.UK

These particulars are for general guidance only. They do not form or constitute any part of an offer or contract. Goodman & Lilley has not carried out structural surveys of the property. The services, appliances or specific fittings mentioned in these details have not been tested. Every attempt is made to ensure accuracy, however all photographs, measurements, floor plans and distances are for illustrative purposes only. They must not be relied upon when purchasing carpets and or other fixtures & fittings. Lease details, service charges and ground rents are given as a guide only. They should be checked and confirmed by a licensed solicitor prior to exchange of contracts. The copyright of all details, photographs and floor plans remain exclusive to Goodman & Lilley.