



24 WEBB COURT PARK ROAD,
BRISTOL, BS11 0FH

**GOODMAN
& LILLEY**



TUCKED AWAY AND SET BACK FROM PARK ROAD IS THIS FANTASTIC BRIGHT AND WELL LOOKED AFTER TWO DOUBLE BEDROOM APARTMENT. SITUATED ON THE EVER POPULAR WEBB COURT, THIS PROPERTY PROVIDES THE PERFECT RETREAT FOR BUYERS SEEKING COMFORT AND CONVENIENCE.

Lounge/Diner

Two uPVC double glazed windows to rear aspect, double doors opening onto Juliet balcony, radiator

Kitchen

uPVC double glazed window to rear aspect, a mixture of eye level and low level storage cupboards with roll top work surfaces, stainless steel sink with mixer tap over, gas hob over oven with extractor over, space for fridge/freezer.

Bathroom

Low level toilet, hand wash basin and panel bath, heated towel rail.

Bedroom 1

uPVC double glazed window to front aspect, radiator, door to en-suite.

Bedroom 2

uPVC double glazed window to front aspect, radiator, storage cupboard.

En-suite

uPVC double glazed window to side aspect, low level toilet, hand wash basin, separate shower cubicle, heated towel rail

Externally

Allocated off street parking, private entrance via green space, access to communal garden.

-
- Onward chain agreed
 - First floor apartment
 - Gated access
 - Master bedroom with en-suite.
 - Juliet balcony
 - Allocated Parking space
 - Village location
 - Close to Shirehampton high street



GUIDE PRICE £225,000



First Floor

Approx. 45.9 sq. metres (494.4 sq. feet)

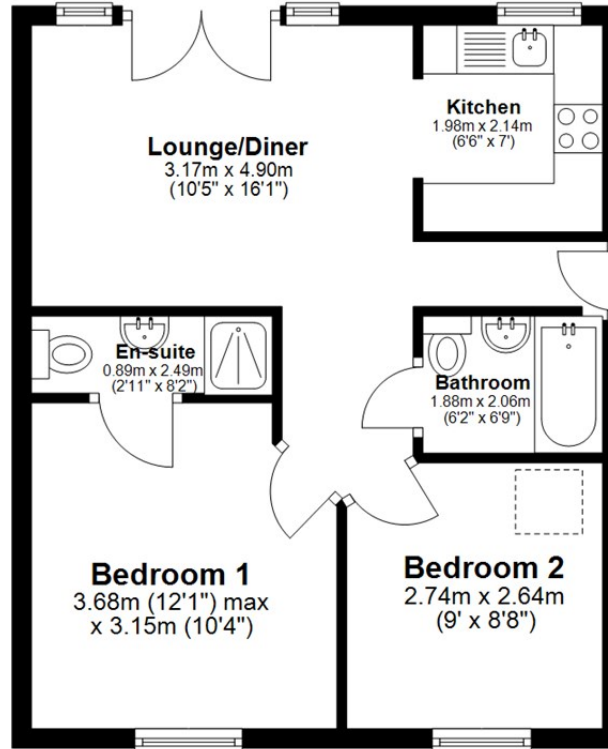

Ground Floor

Approx. 1.4 sq. metres (15.4 sq. feet)

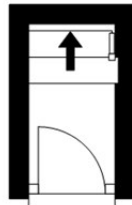

Total area: approx. 47.4 sq. metres (509.8 sq. feet)

HENLEAZE - 0117 2130777
henleaze@goodmanlilley.co.uk

PORTISHEAD - 01275 430440
sales@goodmanlilley.co.uk

SHIREHAMPTON - 0117 2130333
shire@goodmanlilley.co.uk

Zoopla.co.uk

rightmove



WWW.GOODMANLILLEY.CO.UK

These particulars are for general guidance only. They do not form or constitute any part of an offer or contract. Goodman & Lilley has not carried out structural surveys of the property. The services, appliances or specific fittings mentioned in these details have not been tested. Every attempt is made to ensure accuracy, however all photographs, measurements, floor plans and distances are for illustrative purposes only. They must not be relied upon when purchasing carpets and or other fixtures & fittings. Lease details, service charges and ground rents are given as a guide only. They should be checked and confirmed by a licensed solicitor prior to exchange of contracts. The copyright of all details, photographs and floor plans remain exclusive to Goodman & Lilley.