



72 TORMARTON CRESCENT,  
HENBURY, BS10 7LW

---

**GOODMAN  
& LILLEY**



GOODMAN AND LILLEY ARE PROUD TO PRESENT THIS FANTASTIC OPPORTUNITY TO PURCHASE A 3 BEDROOM SEMI DETACHED HOME WITH SIDE PLOT AND PLANNING PERMISSION GRANTED FOR A SEPARATE DWELLING, SEE BRISTOL CITY PLANNING REF NUMBER 23/00694/F

- 
- Three Bedroom Semi Detached House With No Onward Chain
  - Planning Ref number 23/00694/F
  - Close to all Amenities
  - Planning Permission Granted For Further Adjoining Three Bedroom House
  - Big Corner Plot
  - Great Potential.



GUIDE PRICE £365,000



## Ground Floor

Approx. 41.1 sq. metres (442.1 sq. feet)

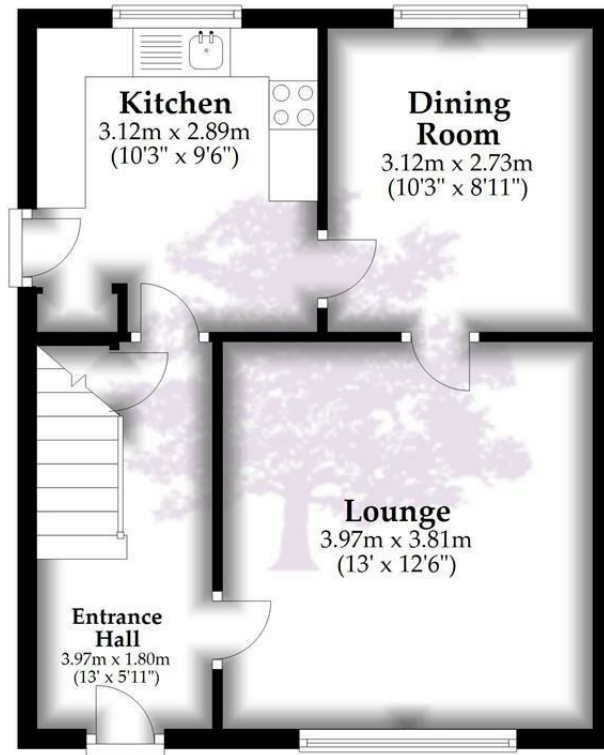

## First Floor

Approx. 44.6 sq. metres (480.6 sq. feet)

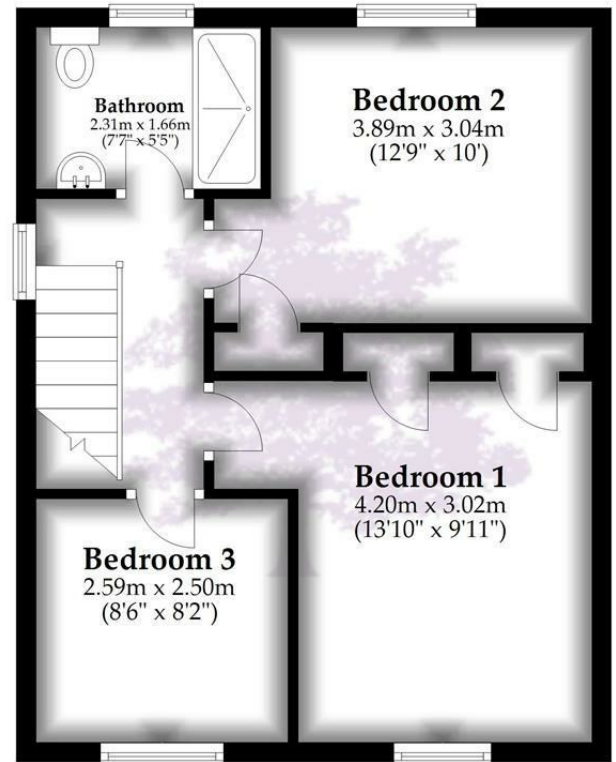

Total area: approx. 85.7 sq. metres (922.7 sq. feet)

Whilst every attempt has been made to ensure accuracy of the floor plan all measurements are approximate and no responsibility is taken for any error, omission or measurement.

Plan produced using PlanUp.

HENLEAZE - 0117 2130777  
henleaze@goodmanlilley.co.uk

PORTISHEAD - 01275 430440  
sales@goodmanlilley.co.uk

SHIREHAMPTON - 0117 2130333  
shire@goodmanlilley.co.uk

Zoopla.co.uk

rightmove



WWW.GOODMANLILLEY.CO.UK

These particulars are for general guidance only. They do not form or constitute any part of an offer or contract. Goodman & Lilley has not carried out structural surveys of the property. The services, appliances or specific fittings mentioned in these details have not been tested. Every attempt is made to ensure accuracy, however all photographs, measurements, floor plans and distances are for illustrative purposes only. They must not be relied upon when purchasing carpets and or other fixtures & fittings. Lease details, service charges and ground rents are given as a guide only. They should be checked and confirmed by a licensed solicitor prior to exchange of contracts. The copyright of all details, photographs and floor plans remain exclusive to Goodman & Lilley.