



FLAT 3 59 PEMBROKE ROAD,  
SHIREHAMPTON, BS11 9SA

---

GOODMAN  
& LILLEY



## A FANTASTIC OPPORTUNITY HAS ARISEN TO PURCHASE THIS 3 DOUBLE BEDROOM PROPERTY IN CENTRAL SHIREHAMPTON.

### Kitchen

uPVC door and window to front aspect, one and a half sink with mixer tap over, mixture of eye level and low level storage units with roll top work surfaces, space for a washing machine, cooker and fridge/freezer, radiator.

### Lounge Area

radiator and door to hallway

### Hallway

Under stairs storage cupboards, stairs to first floor.

### Bedroom 1

Two uPVC double windows to rear aspect, fireplace, radiator

### Bedroom 2

uPVC double glazed window to front aspect, fireplace, radiator

### Bedroom 3

uPVC double glazed window to front aspect, storage cupboard housing boiler, radiator.

### Bathroom

uPVC double glazed window to side aspect, sliding door, panel bath with shower over, low level toilet, pedestal basin

- 
- No Onward Chain
  - Kitchen/Diner
  - 3 Double Bedrooms
  - Cash Buyers Only
  - Village Location
  - Updating Required



£167,500



**Ground Floor**  
Approx. 30.4 sq. metres (327.2 sq. feet)

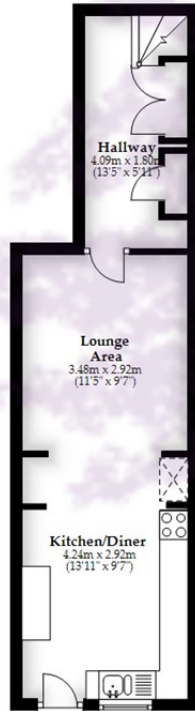

**First Floor**  
Approx. 63.8 sq. metres (686.9 sq. feet)

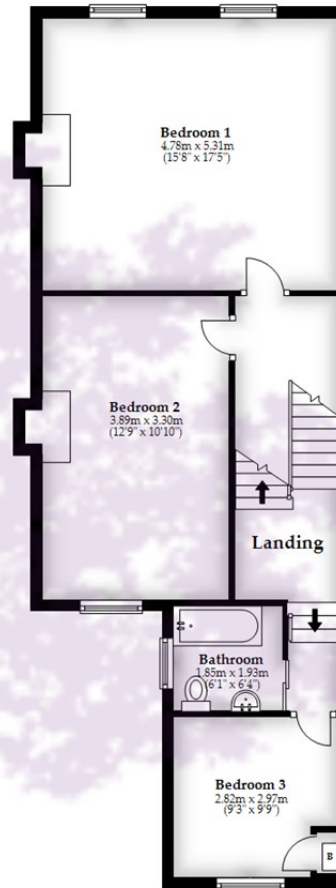

Total area: approx. 94.2 sq. metres (1014.1 sq. feet)

Whilst every attempt has been made to ensure accuracy of the floor plan all measurements are approximate and no responsibility is taken for any error, omission or measurement.  
Plan produced using PlanUp.

**HENLEAZE** - 0117 2130777  
henleaze@goodmanlilley.co.uk

**PORTISHEAD** - 01275 430440  
sales@goodmanlilley.co.uk

**SHIREHAMPTON** - 0117 2130333  
shire@goodmanlilley.co.uk

Zoopla.co.uk

rightmove



**WWW.GOODMANLILLEY.CO.UK**

These particulars are for general guidance only. They do not form or constitute any part of an offer or contract. Goodman & Lilley has not carried out structural surveys of the property. The services, appliances or specific fittings mentioned in these details have not been tested. Every attempt is made to ensure accuracy, however all photographs, measurements, floor plans and distances are for illustrative purposes only. They must not be relied upon when purchasing carpets and or other fixtures & fittings. Lease details, service charges and ground rents are given as a guide only. They should be checked and confirmed by a licensed solicitor prior to exchange of contracts. The copyright of all details, photographs and floor plans remain exclusive to Goodman & Lilley.