



Asking Price £180,000

Introducing a charming and spacious two-bedroom semi-detached home nestled in the sought-after locale of Brentford Avenue, Whiteleigh. Boasting ample living space, this property presents an inviting layout comprising a cosy lounge, a separate dining room perfect for entertaining with double doors leading to the rear garden, and a contemporary fitted kitchen equipped with a range cooker. The accommodation also features two generously proportioned double bedrooms, with the main bedroom offering the flexibility to be split into three separate rooms to suit your needs. Completing the interior is a modern bathroom, ensuring comfort and convenience. Externally, the property showcases expansive front and rear gardens, providing an ideal setting for outdoor relaxation and activities. Additional advantages include the presence of gas central heating and double glazing, ensuring warmth and energy efficiency throughout the seasons. Offered to the market with the added benefit of no onward chain, this property presents a rare opportunity to acquire a delightful residence in a desirable location, perfectly suited for families or professionals seeking a comfortable and convenient lifestyle.

novahomes

Established 2008

 01752 206040

 sales@novahomes.co.uk

 www.novahomes.co.uk

Brentford Avenue, Whiteleigh, PL5 4HD

Accommodation Comprises

Introducing a charming and spacious two-bedroom semi-detached home nestled in the sought-after locale of Brentford Avenue, Whiteleigh. Boasting ample living space, this property presents an inviting layout comprising a cosy lounge, a separate dining room perfect for entertaining with double doors leading to the rear garden, and a contemporary fitted kitchen equipped with a range cooker. The accommodation also features two generously proportioned double bedrooms, with the main bedroom offering the flexibility to be split into three separate rooms to suit your needs. Completing the interior is a modern bathroom, ensuring comfort and convenience.

Externally, the property showcases expansive front and rear gardens, providing an ideal setting for outdoor relaxation and activities. Additional advantages include the presence of gas central heating and double glazing, ensuring warmth and energy efficiency throughout the seasons.

Offered to the market with the added benefit of no onward chain, this property presents a rare opportunity to acquire a delightful residence in a desirable location, perfectly suited for families or professionals seeking a comfortable and convenient lifestyle.

Entrance Hall

Lounge 3.84m (12'7") x 3.2m (10'6")

Dining Room 2.72m (8'11") x 2.69m (8'10")

Kitchen 3.02m (9'11") x 2.92m (9'7")

First Floor Landing

Bedroom One 4.83m (15'10") x 3.4m (11'2")

Bedroom Two 3.58m (11'9") x 2.59m (8'6")

Bathroom

Viewing Arrangements

Viewing strictly by appointment through the agent. Please respect the occupier's privacy and do not make an approach by knocking on the door.





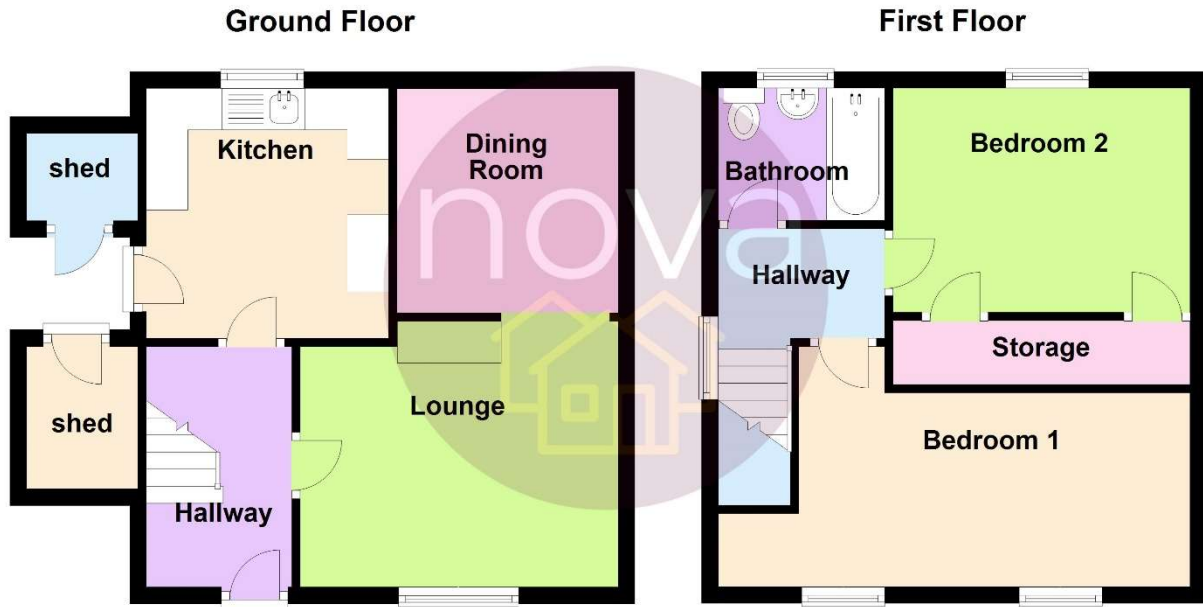

Whilst every attempt has been made to ensure the accuracy of the floor plan contained here, measurements of doors, windows, rooms and any other items are approximate and no responsibility is taken for any error, omission or mis-statement. This plan is for illustrative purposes only and should be used as such by any prospective purchaser. The services, systems and appliances shown have not been tested and no guarantee as to their operability or efficiency can be given.

Plan produced using PlanUp.

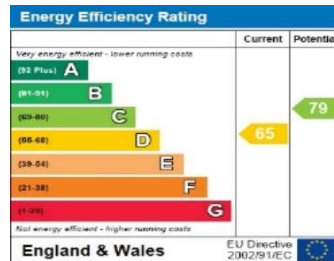

Notice: Please note we have not tested any apparatus, fixtures, fittings, or services. Interested parties must undertake their own investigation into the working order of these items. All measurements are approximate and photographs provided for guidance only.

