

Plot 2 Station Road  
Edderton, Ross-Shire, IV19 1LA



Fixed Asking Price £180,000



A new development of a 2 bedroom semi detached bungalow located in the hamlet of Edderton just 5 miles west of the town of Tain. The new build property is constructed by a local builder with a superb reputation to a high specification with excellent finishes.



## Area Map

### LAYOUT

The property is a 2 bedroom semi detached with garden front and rear. The property has 2 bedrooms and open plan sitting room, kitchen and a shower room, a large storage cupboard in the hall.

### CONSTRUCTION

The Bungalow (60 Sq m) is constructed to building warrant standards for high efficiency and comfort. The windows are UPVC in anthracite grey, Redland Regent Tile slate grey, White dry dash harling and concrete paving around house.

### PLANNING INFORMATION

Highland Council Planning Reference  
23/04238/FUL

### LOCATION

Edderton is a hamlet 5 miles west of the historic town of Tain with all the local amenities such as doctors, local shops, supermarkets, pubs, restaurants, train and bus links



Ground Floor



For illustrative purposes only. Produced by Monster Moves Ltd 2024  
Plan produced using PlanUp.

**Plot 2, Station Road, Edderton**

Ground Floor

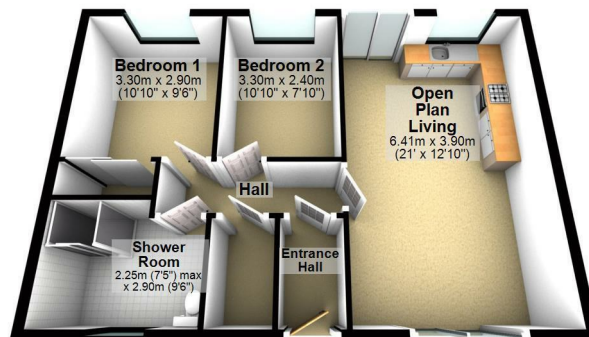

For illustrative purposes only. Produced by Monster Moves Ltd 2024  
Plan produced using PlanUp.

**Plot 2, Station Road, Edderton**



Thistle House, Main Street, Golspie, KW10 6TG  
sales@monster-moves.co.uk  
www.monster-moves.co.uk  
Sutherland - 01408 525001  
Inverness - 01463 263063



monstermoveshighland



monster\_moves\_estate\_agents





**3 West Elevation Plot 2**  
1 : 50



**2 East Elevation Plot 2**  
1 : 50



Thistle House, Main Street, Golspie, KW10 6TG  
 sales@monster-moves.co.uk  
 www.monster-moves.co.uk  
 Sutherland - 01408 525001  
 Inverness - 01463 263063



monstermoveshighland



monster\_moves\_estate\_agents

