

East Ferry Road, London, E14 3LH

£395,000

🛏️ 1 🚿 1 🚗 1



- 3rd Floor One Bedroom Apartment
- Chain Free
- Wood Flooring
- Bright Neutral Decoration
- Service Charge 1,567.66 P.A.
- Private Balcony
- Well Proportioned Reception Room
- Secure Gated Parking
- Ground Rent £150.00
- Council Tax Band C

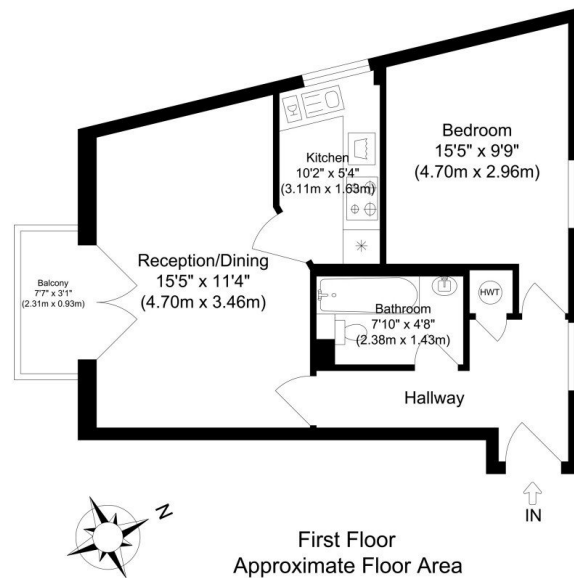

First Floor
Approximate Floor Area
469.30 sq. ft.
(43.60 sq. m)

Peninsula Court

TOTAL APPROX FLOOR AREA 469.30 SQ. FT. (43.60 SQ. M)

Whilst every attempt has been made to ensure the accuracy of the floor plan contained here, measurements of doors, windows, rooms and any other items are approximate and no responsibility is taken for any error, omission or misstatement. This plan is for illustrative purposes only and should be used as such by any prospective purchaser.

Henry Wiltshire are pleased to present is this one-bedroom apartment situated on the third floor of this secure development of Peninsula Court. Bright and neutrally presented throughout.