



Churchill Court

Mortlake, SW14

SHORT LET

£2,800 per month
(£646.15 per week)

Set in a modern development moments from the River Thames is this stunning one bedroom apartment.

The property comprises; a spacious open plan reception room with a fully integrated contemporary kitchen, a large stylish bathroom and a generous master bedroom which benefits from a built in wardrobe.

Wadham Mews is off Williams Lane in a quiet location adjacent to the River Thames offering easy access to Mortlake Green and Sheen Lane. Mortlake train station is within very close proximity to provide a good service into London Waterloo, The City and the West End.



Churchill Court

Wadham Mews, SW14

- Modern Apartment
- One Bedroom
- Modern Décor
- Allocated Parking
- Part Furnished



Minimum Term: 2 months
Deposit Required: £1,292.31
Local Authority: Richmond upon Thames
Council Tax Band: D
EPC Rating: C
Furnished

Energy Efficiency Rating		Current	Potential
Very energy efficient - lower running costs	A		
(92-100)	B		
(81-91)	C	75	75
(69-80)	D		
(55-68)	E		
(39-54)	F		
(21-38)	G		
Not energy efficient - higher running costs			
England, Scotland & Wales		EU Directive 2002/91/EC	

Chestertons East Sheen Lettings

254a Upper Richmond Road West
 East Sheen
 London
 SW14 8AG
 sheen@chestertons.co.uk
 02081040580
 chestertons.co.uk

Additional tenant charges apply (fees apply to non-AST tenancies only)
 Tenancy Agreement Fee: £300
 References per Tenant/Guarantor: £60
 Inventory check (approx. £100 – £250 inc. VAT)
chestertons.co.uk/property-to-rent/applicable-fees

Churchill Court, Wadham Mews, SW14

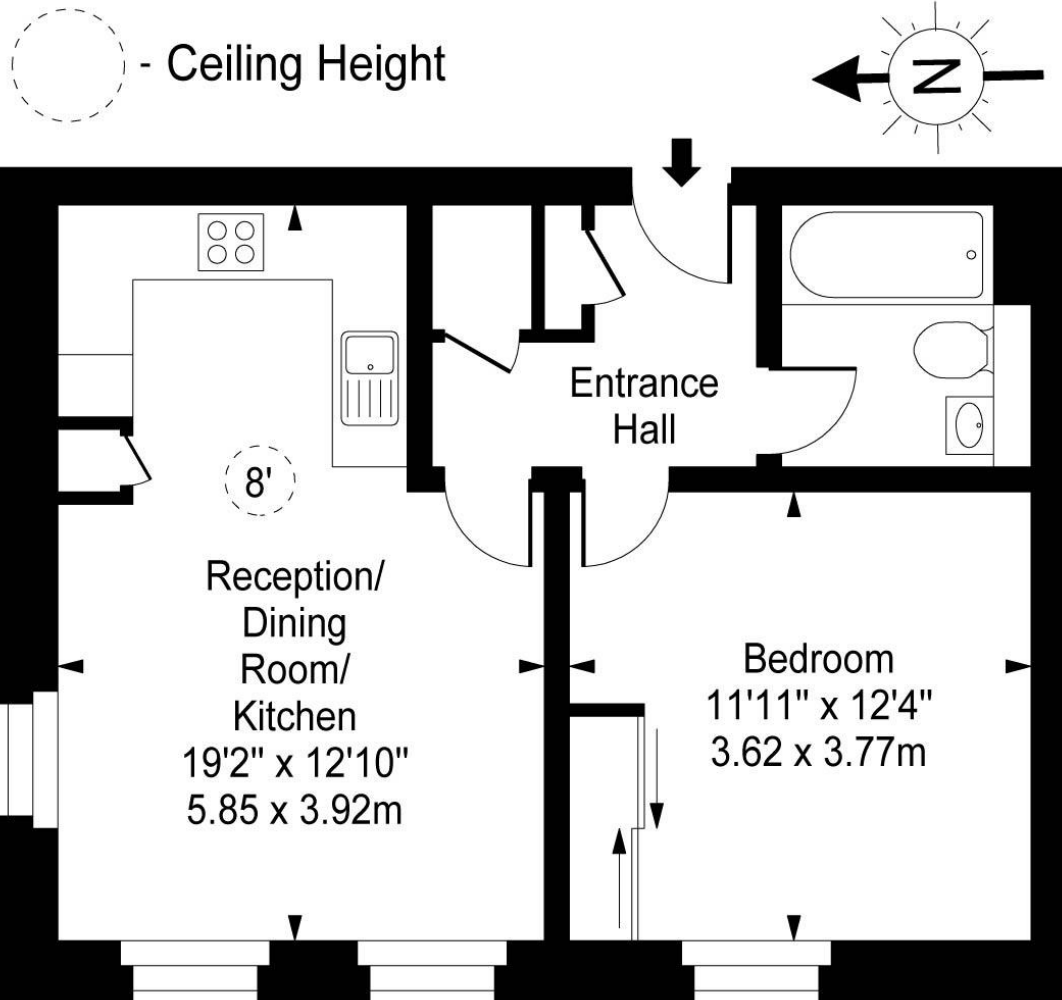

Ground Floor

Approx Gross Internal Area **495 Sq Ft - 46.00 Sq M**

For Illustration Purposes Only - Not To Scale

www.goldlens.co.uk

Ref. No. 014874AG

