



Elm Road

East Sheen, SW14

£2,200 per month
(£507.69 per week)

A lovely first floor two double bedroom period conversion situated in the heart of East Sheen and a short walk from Mortlake station.



Elm Road

London, SW14

- Period conversion
- 2 bedrooms
- Popular road in the heart of East Sheen
- First floor flat
- Close to Mortlake Station
- Unfurnished
- Long let



A lovely two double bedroom conversion flat occupying the entire first floor of an attractive Victorian property.

The open plan kitchen/reception room benefits from large sash windows making it light and airy. The property also comprises two spacious double bedrooms.

This property is close to the local amenities East Sheen has to offer including Mortlake Station, Waitrose, Thomson House School and St Mary Magdalen's School.

Minimum Term: 12 months
Deposit Required: £2,538.46
Local Authority: Richmond upon Thames
Council Tax Band: D
EPC Rating: D
Unfurnished

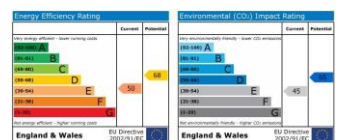

Chestertons East Sheen Lettings

254a Upper Richmond Road West
East Sheen
London
SW14 8AG
sheen@chestertons.co.uk
02081040580
chestertons.co.uk

Additional tenant charges apply (fees apply to non-AST tenancies only)
Tenancy Agreement Fee: £300
References per Tenant/Guarantor: £60
Inventory check (approx. £100 – £250 inc. VAT)
chestertons.co.uk/property-to-rent/applicable-fees

Elm Road, SW14

Approximate gross internal area

61 sq m / 657 sq ft

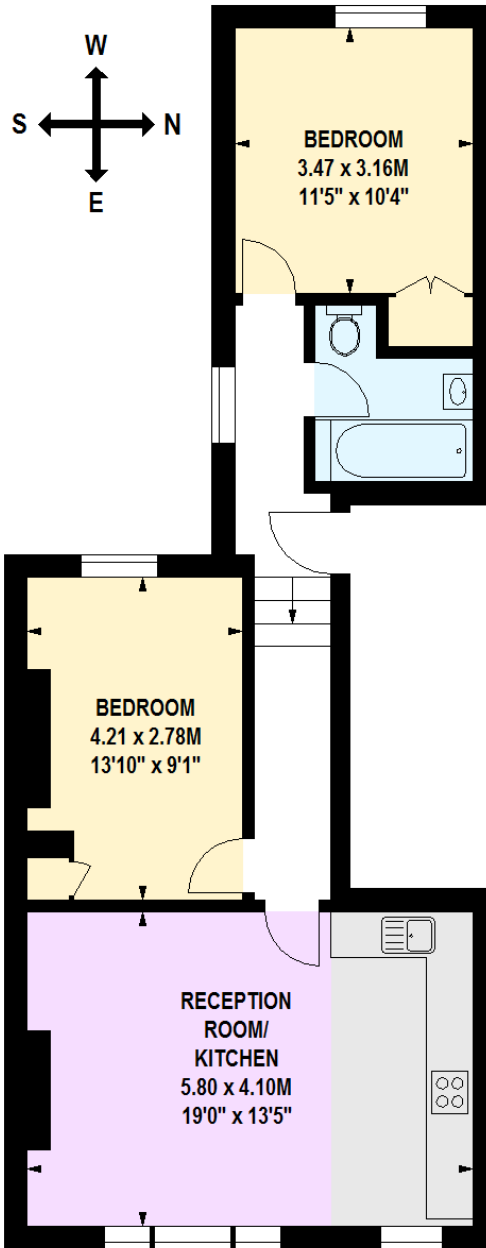

First Floor

Illustration for identification purposes only, not to scale

All measurements are maximum, and includes wardrobes and window bays where applicable

Prepared by Mays Floorplans © . Tel 020 8871 4668

