

Because life is

PettyTM
Real

228 North Light Parade
Brierfield
BB9 5FG



For Sale

Reduced £159,950

- Prestigious Northlight development
- Views towards Pendle Hill
- Spacious 2nd floor apartment
- Two double bedrooms
- En-suite and house bathroom

- Open-plan living/dining/kitchen
- AEG integrated appliances
- Utility room and store cupboard
- Secure underground parking
- Additional outdoor parking space



Located within the prestigious Northlight development in Brierfield, this spacious and contemporary second-floor apartment offers modern living with beautiful views towards Pendle Hill. Perfectly suited to professionals, downsizers, or couples seeking style and convenience, the apartment enjoys an enviable position close to a range of local amenities including shops, supermarkets, restaurants, and leisure facilities. Brierfield train station is only a short walk away, offering excellent commuter links to Burnley, Colne, and beyond, while the nearby M65 motorway provides easy access to the wider region.

Upon entering, a welcoming hallway leads into a generous open-plan living, dining, and kitchen area designed for modern lifestyles. The sleek kitchen is fitted with high-quality AEG integrated appliances and offers ample worktop and storage space. Large windows allow plenty of natural light and showcase the stunning open views towards Pendle Hill, creating a bright and relaxing living environment.

There are two well-proportioned double bedrooms, including a main bedroom complemented by a stylish en-suite shower room. A further modern house bathroom serves the second bedroom and guests. A separate utility room and a large store cupboard add further practicality.

Externally, the property benefits from secure underground parking and an additional outdoor parking space. Combining comfort, convenience, and an exceptional setting, this apartment delivers low-maintenance living within one of Brierfield's most desirable developments.

No onward chain.

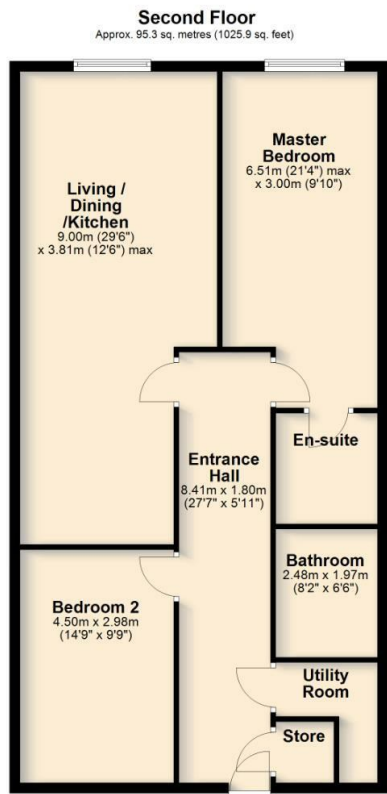

Total area: approx. 95.3 sq. metres (1025.9 sq. feet)

All floorplans provided are for guidance only. Please check all dimensions before making any decisions reliant upon them.
Plan produced using PlanUp.



These particulars, whilst believed to be accurate are set out as a general outline only for guidance and do not constitute any part of an offer or contract. Intending purchasers should not rely on them as statements of representation of fact, but must satisfy themselves by inspection or otherwise as to their accuracy. No person in this firm's employment has the authority to make or give any representation or warranty in respect of the property.