

Because life is

Petty<sup>TM</sup>  
Real

1 Long Meadow  
Colne  
BB8 0PR



## For Sale

- Stylish three-storey townhouse in a sought-after location
- Ground floor with integral garage and entrance hallway
- Lounge on the first floor offering a bright and spacious living area
- High-end kitchen with Siemens appliances
- Modern three-piece bathroom finished to a high standard

## Offers In The Region Of £259,950

- Substantial conservatory with underfloor heating
- 3 Bedrooms
- Substantial garage & utility
- Flexible layout ideal for families or home working
- Convenient setting close to schools, shops, and transport links





Located in the popular Long Meadow development in Colne, this stylish three-storey townhouse offers modern, flexible living with high-quality finishes throughout. Designed to suit a wide range of buyers, the property combines a sleek interior with practical accommodation, all within easy reach of local schools, shops, and transport connections.

The ground floor is centred around practicality and convenience, featuring an integral garage that provides secure parking or useful storage space. From the entrance hallway, a staircase leads directly to the first floor, where the main living accommodation begins.

The first floor forms the heart of the home, offering an elegant lounge with ample natural light and space for both relaxation and entertaining. Adjoining the lounge is a beautifully fitted kitchen, showcasing premium Siemens appliances and modern cabinetry, perfect for those who enjoy cooking and dining in style. To the rear, a bright conservatory extends the living area and creates a seamless link with the garden, providing a versatile space for dining, entertaining, or unwinding.

The upper floor accommodates the well-proportioned bedrooms, each offering comfort and flexibility for family living or home working. These are served by a contemporary three-piece bathroom, finished to a high standard with stylish fixtures and fittings, ensuring everyday practicality with a touch of luxury.

Externally, the property features a private garden to the rear, ideal for outdoor dining and relaxation. With its garage, conservatory, high-specification kitchen, and thoughtfully arranged accommodation across three storeys, this townhouse represents a rare opportunity to acquire a stylish, modern home in a highly regarded part of Colne.

One of the standout features of this property is its elevated position, which affords far reaching views over the surrounding countryside and rolling hills of Boulsworth.

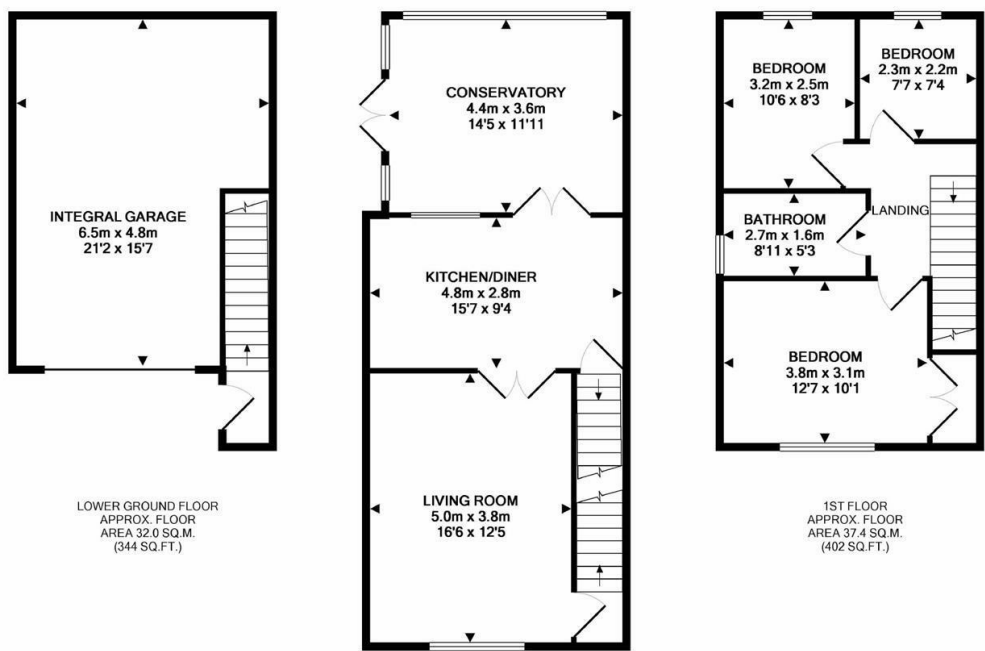

GROUND FLOOR  
APPROX. FLOOR  
AREA 53.4 SQ.M.  
(575 SQ.FT.)  
TOTAL APPROX. FLOOR AREA 122.8 SQ.M. (1321 SQ.FT.)  
Whilst every attempt has been made to ensure the accuracy of the floor plan contained here, measurements of doors, windows, rooms and any other items are approximate and no responsibility is taken for any error, omission, or mis-statement. This plan is for illustrative purposes only and should be used as such by any prospective purchaser. The services, systems and appliances shown have not been tested and no guarantee as to their operability or efficiency can be given  
Made with Metropix ©2019



These particulars, whilst believed to be accurate are set out as a general outline only for guidance and do not constitute any part of an offer or contract. Intending purchasers should not rely on them as statements of representation of fact, but must satisfy themselves by inspection or otherwise as to their accuracy. No person in this firms employment has the authority to make or give any representation or warranty in respect of the property.