

Because life is

PettyTM
Real

6 Portland Street
Colne
BB8 0LX



For Sale

- Mid-terrace
- Popular location
- Ideal for a first time buyer
- Central heating & double glazing
- Lounge

Offers Around £99,950

- Dining kitchen
- Two bedrooms
- Three piece bathroom
- Rear Yard
- No chain



Located on Portland Street in the heart of Colne, this well-presented mid-terrace property offers an ideal opportunity for first-time buyers, investors, or those looking to downsize. Situated within walking distance of local shops, schools, and transport links, the home enjoys a convenient position in a popular residential area.

The property opens into a comfortable lounge, providing a cosy space for relaxing or entertaining. Neutral décor and a traditional layout make it a blank canvas ready for personal touches.

To the rear, the spacious dining kitchen offers ample room for both cooking and dining. With fitted units and space for appliances, it serves as a practical and sociable area ideal for day-to-day living.

Upstairs, the property offers two good-sized bedrooms, including a generous main bedroom and a second room suitable for guests, children, or use as a home office. A three-piece bathroom suite completes the first floor, comprising a bath with overhead shower, wash basin, and WC.

Externally, the rear yard offers low-maintenance outdoor space with room for seating or storage. The property is offered for sale with no onward chain, allowing for a smooth and hassle-free purchase. A great opportunity in a well-connected part of town.

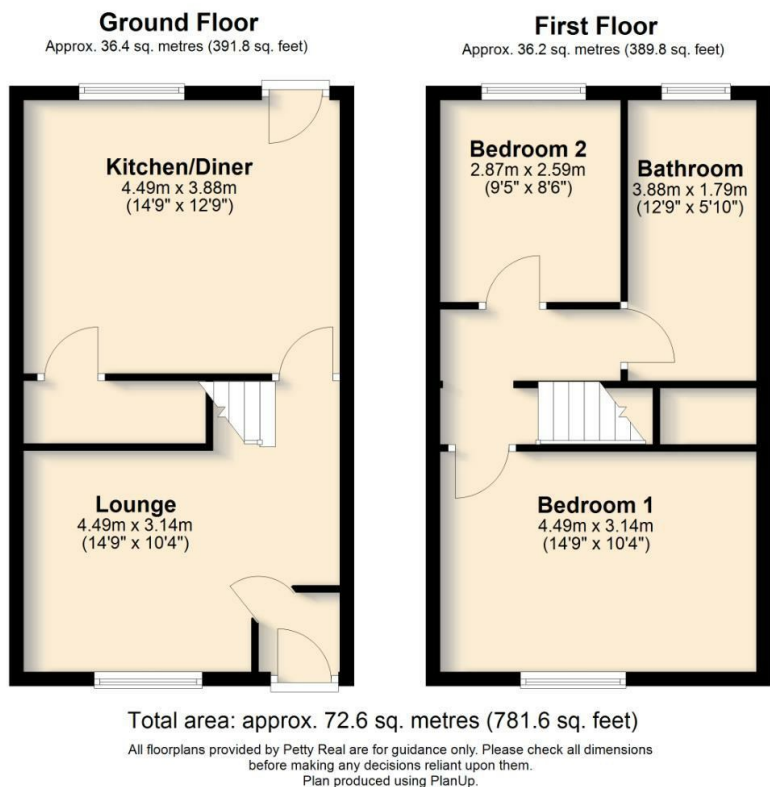

These particulars, whilst believed to be accurate are set out as a general outline only for guidance and do not constitute any part of an offer or contract. Intending purchasers should not rely on them as statements of representation of fact, but must satisfy themselves by inspection or otherwise as to their accuracy. No person in this firm's employment has the authority to make or give any representation or warranty in respect of the property.