

Because life is

PettyTM Real

30 Beresford Street
Nelson
BB9 0JB



For Sale

Price £60,000

- Mid-terrace
- Popular location
- Ideal for first time buyer or landlord
- Lounge
- Kitchen

- Two bedrooms
- Bathroom
- Yard
- Garden to the front
- No chain



This two-bedroom terraced home offers a fantastic opportunity for buyers looking to put their own stamp on a property. Situated in a convenient location, this home provides comfortable living space with the potential for some refurbishment to make it truly your own. With a welcoming layout, it's perfect for first-time buyers or investors seeking a project.

The ground floor features a spacious lounge area, ideal for relaxing or entertaining guests. The kitchen, located at the rear of the property, provides ample space for meal preparation and can be updated to fit modern tastes. Both rooms offer a great canvas for customization, allowing you to create the home that suits your style.

Upstairs, there are two well-sized bedrooms offering comfortable sleeping arrangements. These rooms can be adapted to suit your needs, whether as bedrooms or as an office or hobby space. The bathroom also offers refurbishment potential, ready for a modern touch.

Externally, the property benefits from a front garden that provides an inviting entrance, while the rear features a practical yard. This outdoor space is ideal for storage or creating a cozy seating area. With some updates, this terraced home could become a delightful and personalized living space.

No onward chain.

Ground Floor

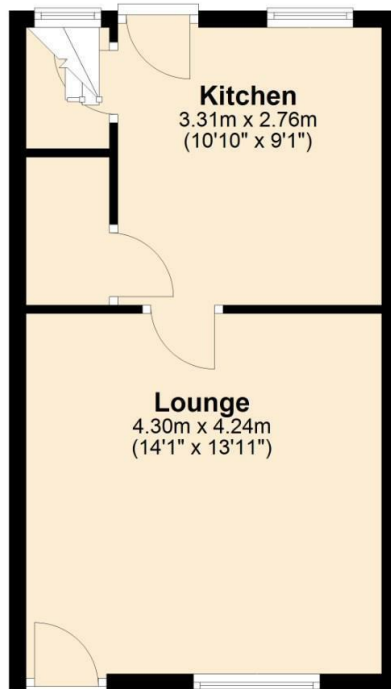

First Floor

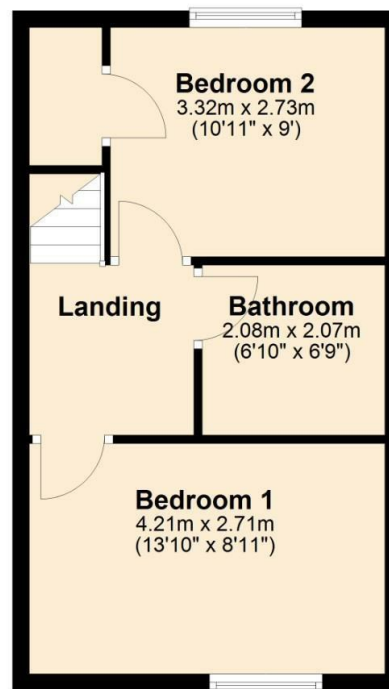

Total area: approx. 63.9 sq. metres (687.9 sq. feet)



These particulars, whilst believed to be accurate are set out as a general outline only for guidance and do not constitute any part of an offer or contract. Intending purchasers should not rely on them as statements of representation of fact, but must satisfy themselves by inspection or otherwise as to their accuracy. No person in this firm's employment has the authority to make or give any representation or warranty in respect of the property.

11 Albert Road, Colne, Lancashire, BB8 0RY
T. 01282 868686
Colne.sales@pettyreal.co.uk

www.pettyreal.co.uk