

Because life is

PettyTM
Real

214 Brunswick Street
Nelson
BB9 0JH



For Sale

- Refurbished modern mid terrace
- Popular location
- Turn key ready
- Ideal for a first time buyer
- Lounge

Offers In Excess Of £95,000

- New kitchen
- New bathroom
- Two double bedrooms
- Garden forecourt
- Rear yard



Located in a popular location on Brunswick Street in Nelson, this beautifully modernised property offers the perfect blend of contemporary style and comfort. With every detail thoughtfully updated, the home is turn-key ready, requiring no further renovations or improvements. Its location provides easy access to local amenities and transport links, making it ideal for first-time buyers or those looking to downsize.

The property features a spacious lounge, designed to offer a welcoming and relaxing environment. Complementing this is a modern dining kitchen, fully equipped with high-end appliances and ample space for both dining and cooking. The layout ensures that the heart of the home remains both functional and stylish, perfect for entertaining guests or enjoying family meals.

Upstairs, the property boasts two generously-sized double bedrooms, both tastefully decorated and filled with natural light. These versatile spaces can comfortably accommodate various furniture arrangements, making them ideal for creating a cosy retreat. The sleek, modern three-piece bathroom offers a luxurious feel, with a bathtub, shower, and contemporary fixtures throughout.

The property also benefits from a low-maintenance rear yard, perfect for outdoor relaxation or a small garden setup. With Hive-operated central heating and double glazing throughout, this home ensures both energy efficiency and comfort all year round.

No chain.

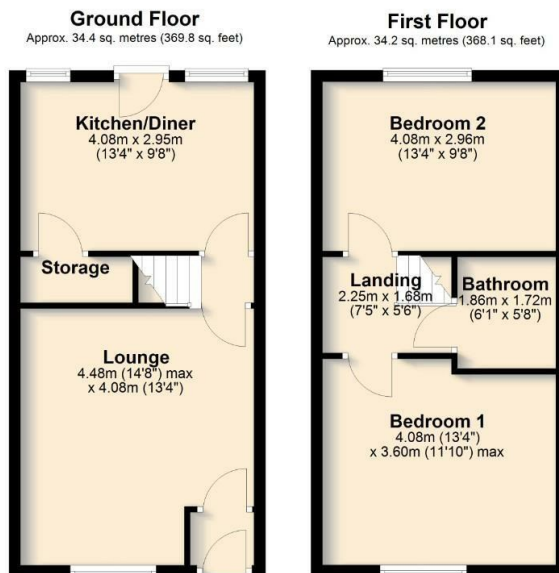

Total area: approx. 68.6 sq. metres (737.9 sq. feet)



These particulars, whilst believed to be accurate are set out as a general outline only for guidance and do not constitute any part of an offer or contract. Intending purchasers should not rely on them as statements of representation of fact, but must satisfy themselves by inspection or otherwise as to their accuracy. No person in this firm's employment has the authority to make or give any representation or warranty in respect of the property.

11 Albert Road, Colne, Lancashire, BB8 0RY
T. 01282 868686
Colne.sales@pettyreal.co.uk

www.pettyreal.co.uk