

ARDEN & WAY

BLOCK MANAGEMENT & LETTINGS



23 Sandy Beach Estate

, Hayling Island, PO11 9RG

£1,400

Arden & Way is delighted to offer this unique three-bedroom detached upside-down home, set within the highly sought-after Sandy Beach Estate on Hayling Island's tranquil southeastern tip. Perfectly positioned between the coastline and the Nature Reserve, it boasts exceptional panoramic views across Portsmouth Harbour towards The Willingoes and East Head.

Located on a private estate with a central green and residents' tennis court, the property features three bedrooms and a modern bathroom on the ground floor, with a bright open-plan kitchen/dining/living space upstairs opening onto a decked balcony to enjoy the stunning outlook. Additional benefits include double glazing, a recently fitted gas heating system, private driveway, large garage, and a low-maintenance courtyard garden.

Just moments from the sailing club and Sparkes Marina, this rare coastal home offers peace, community, and convenience. Contact Arden & Way to arrange a viewing.

Viewing

Please contact our Arden & Way Office on 02392 460 899 if you wish to arrange a viewing appointment for this property or require further information.



3



1



1

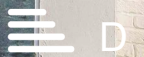

D

Floor Plan

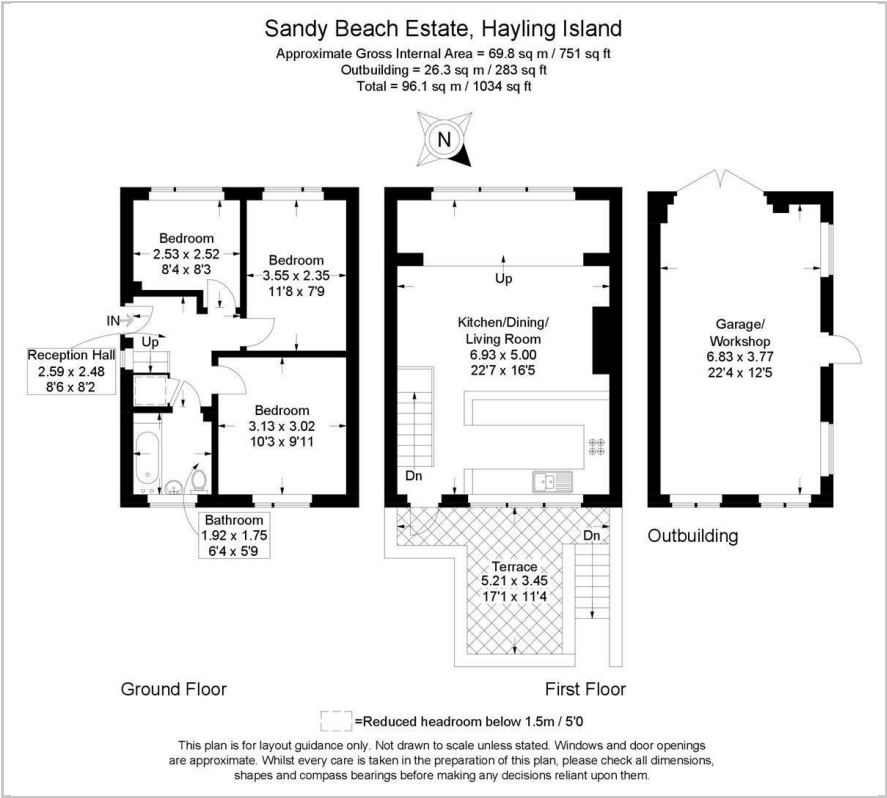

Area Map



Energy Efficiency Graph

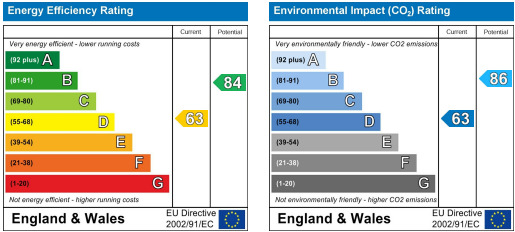

These particulars, whilst believed to be accurate are set out as a general outline only for guidance and do not constitute any part of an offer or contract. Intending purchasers should not rely on them as statements of representation of fact, but must satisfy themselves by inspection or otherwise as to their accuracy. No person in this firms employment has the authority to make or give any representation or warranty in respect of the property.