

ARDEN & WAY

BLOCK MANAGEMENT & LETTINGS



15 Sinah Lane

, Hayling Island, PO11 0EY

£700,000

Arden & Way are delighted to present to the market this beautifully presented three-bedroom detached chalet-style bungalow, located on the highly sought-after Sinah Lane, on the desirable west side of Hayling Island. This immaculate home offers generous living space throughout and sits proudly on a spacious plot, making it an ideal choice for families and those seeking a high-quality coastal lifestyle.

Upon arrival, the property immediately impresses with ample off-road parking for several vehicles, leading up to an attractive large driveway leading to the entrance porch, boasting a bright welcoming and versatile reception hall with an open-plan living and dining space—ideal for hosting friends and family. The ground floor accommodation is thoughtfully appointed and finished to a high standard, featuring a large, bright living room that flows seamlessly into a spacious kitchen/dining area. This modern space is perfect for entertaining, complete with high-end appliances, sleek cabinetry, and a large island with breakfast bar that opens out to the rear garden, flooding the room with natural light. Also on the ground floor is a large, well-sized double bedroom, a contemporary family bathroom fitted with quality fixtures and a large double shower, and a master bedroom with a private and luxurious retreat.

The single-level rear garden is a true highlight of the home—mainly laid to lawn and bordered by mature shrubs and fencing for privacy. A paved patio area provides the perfect spot for alfresco dining or simply relaxing in the sun.

An internal viewing is highly recommended to fully appreciate the quality, space and lifestyle this exceptional property has to offer. For more information please contact Arden & Way.

Viewing

Please contact our Arden & Way Office on 02392 460 899 if you wish to arrange a viewing appointment for this property or require further information.



3



2



2



Floor Plan

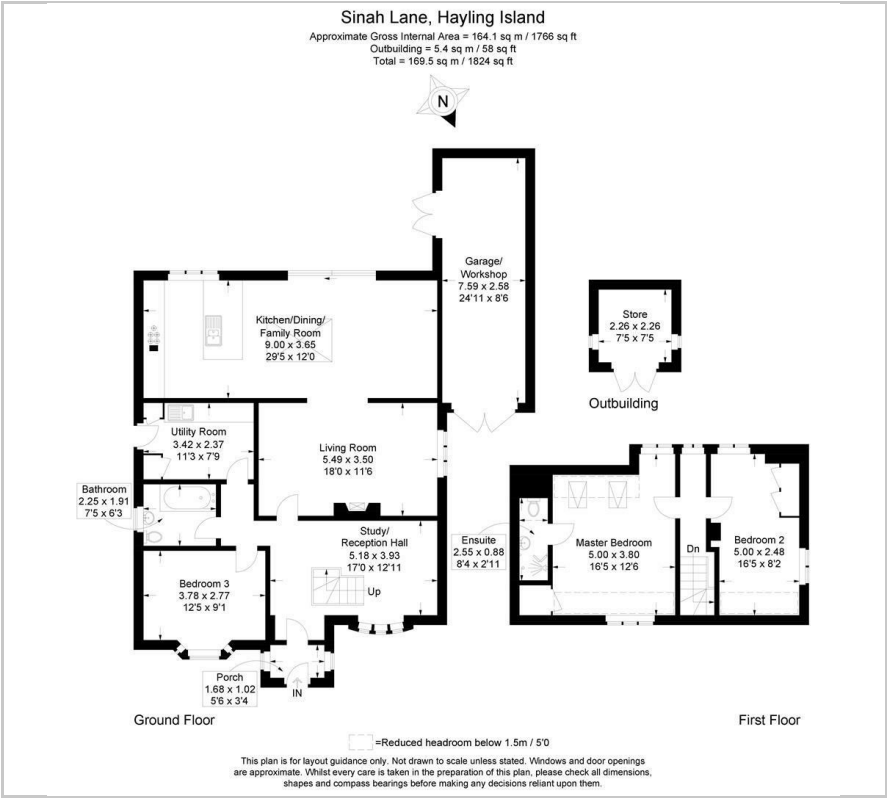

Area Map



Energy Efficiency Graph



These particulars, whilst believed to be accurate are set out as a general outline only for guidance and do not constitute any part of an offer or contract. Intending purchasers should not rely on them as statements of representation of fact, but must satisfy themselves by inspection or otherwise as to their accuracy. No person in this firms employment has the authority to make or give any representation or warranty in respect of the property.

120 Elm Grove, Hayling Island, Hampshire, PO11 9EH

Tel: 02392 460 899

Email: info@ardenway.co.uk

www.ardenway.co.uk