

# ARDEN & WAY

## BLOCK MANAGEMENT & LETTINGS



2b Selsmore Avenue

, Hayling Island, PO11 9PB

**Asking price £525,000**

Welcome to your dream home! This stunning 3-bedroom detached family home, complete with a study or optional 4th bedroom, is ready to embrace its new owners. Just three years ago, it underwent a fabulous renovation and is now the epitome of modern living.

Step inside and be greeted by a welcoming hallway that leads you to your new favourite spot: the kitchen. With its elegant shaker-style design, high quality quartz worktops, Bosch appliances, butter sink and a flow into the open-plan dining area, it's perfect for family gatherings or entertaining friends. Bifold doors open up to reveal an extremely spacious garden, letting in plenty of natural light and creating a seamless indoor-outdoor harmony.

The lounge at the front is cozy yet contemporary, boasting a large window and a chic entertainment unit with a modern fireplace. For those who work from home, there's a well-sized office space or 4th bedroom, and a fresh shower room featuring a sleek glass shower screen.

Head upstairs to find three beautifully appointed bedrooms. The master offers serene garden views, the second is another generous double, and the third is a perfect single for a child or guest room. The minimalist designed family bathroom with a freestanding bath adds a touch of luxury.

Outside, enjoy a large private garden with kids play park, ideal for family activities and relaxation. The driveway provides ample parking, side access and leads to a garage with utility room access.

With its perfect blend of comfort, style, and functionality, this home truly has it all. Close proximity to marina, beach and local amenities. Don't miss out on this unique opportunity. Schedule your viewing today!

### Viewing

Please contact our Arden & Way Office on 02392 460 899 if you wish to arrange a viewing appointment for this property or require further information.



3



2



2





Floor Plan

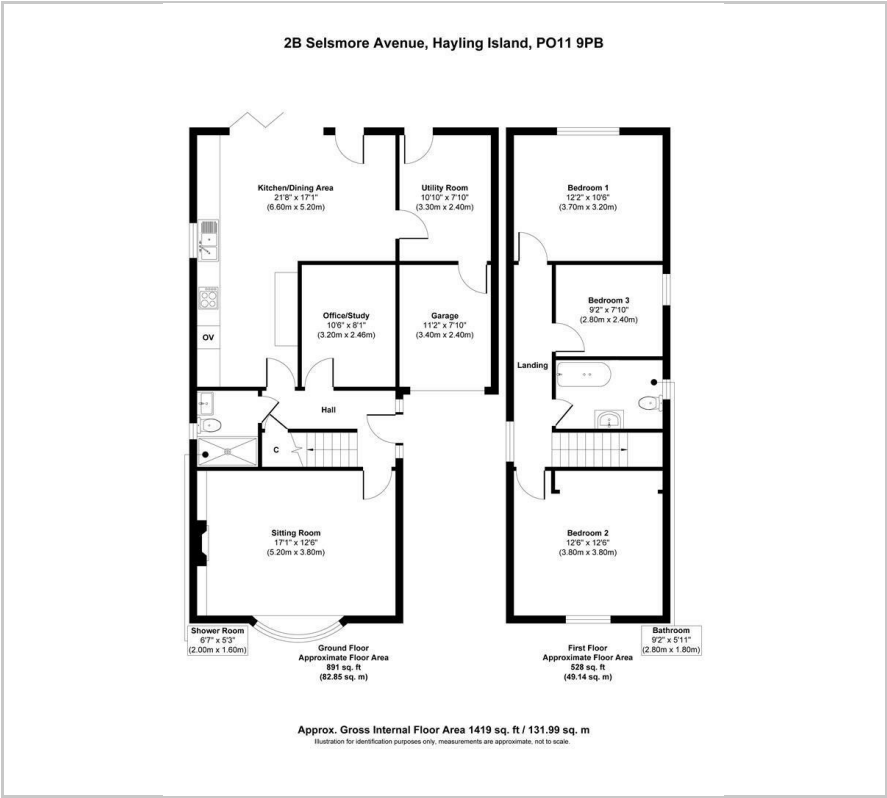

Area Map

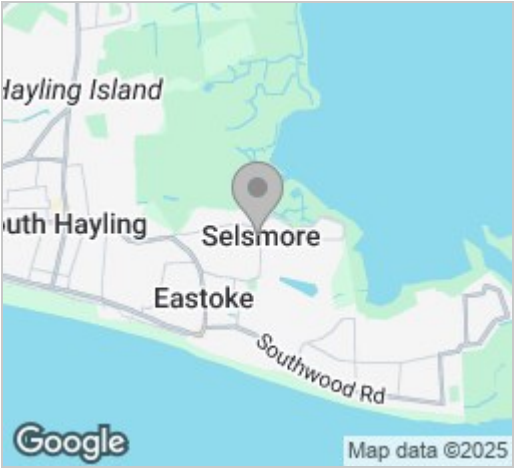

Energy Efficiency Graph

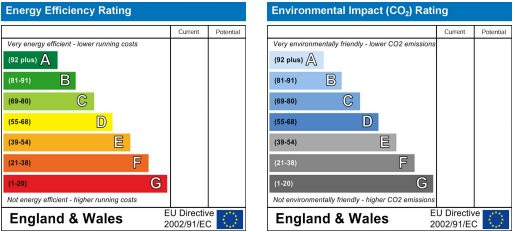

These particulars, whilst believed to be accurate are set out as a general outline only for guidance and do not constitute any part of an offer or contract. Intending purchasers should not rely on them as statements of representation of fact, but must satisfy themselves by inspection or otherwise as to their accuracy. No person in this firms employment has the authority to make or give any representation or warranty in respect of the property.

120 Elm Grove, Hayling Island, Hampshire, PO11 9EH

Tel: 02392 460 899

Email: [info@ardenway.co.uk](mailto:info@ardenway.co.uk)

[www.ardenway.co.uk](http://www.ardenway.co.uk)