

ARDEN & WAY

BLOCK MANAGEMENT & LETTINGS



25 Angerstein Road

, Portsmouth, PO2 8HL

£275,000

Arden & Way are delighted to offer to the sales market this deceptively spacious terraced home situated in a popular North End location, close to local amenities and transport links.

This home offers spacious rooms throughout with downstairs comprising of front aspect lounge with a bay window and immaculate fireplace creating a focal point for the room. To the rear of the property is an extended kitchen/dining area which offers a wonderful social space! French doors open on to the fence enclosed private South facing garden with decking area, also benefitting from an outbuilding to the rear of the garden, which also offers rear access. Finally, the downstairs accommodation boasts a convenient W/C. Upstairs you will find three good sized double bedrooms, two of which have built in cupboards. Neutrally decorated family bathroom completes the accommodation on offer at this beautiful family home.

For more information or to arrange a viewing please contact Arden & Way!

Viewing

Please contact our Arden & Way Office on 02392 460 899 if you wish to arrange a viewing appointment for this property or require further information.



3



1



1



Floor Plan

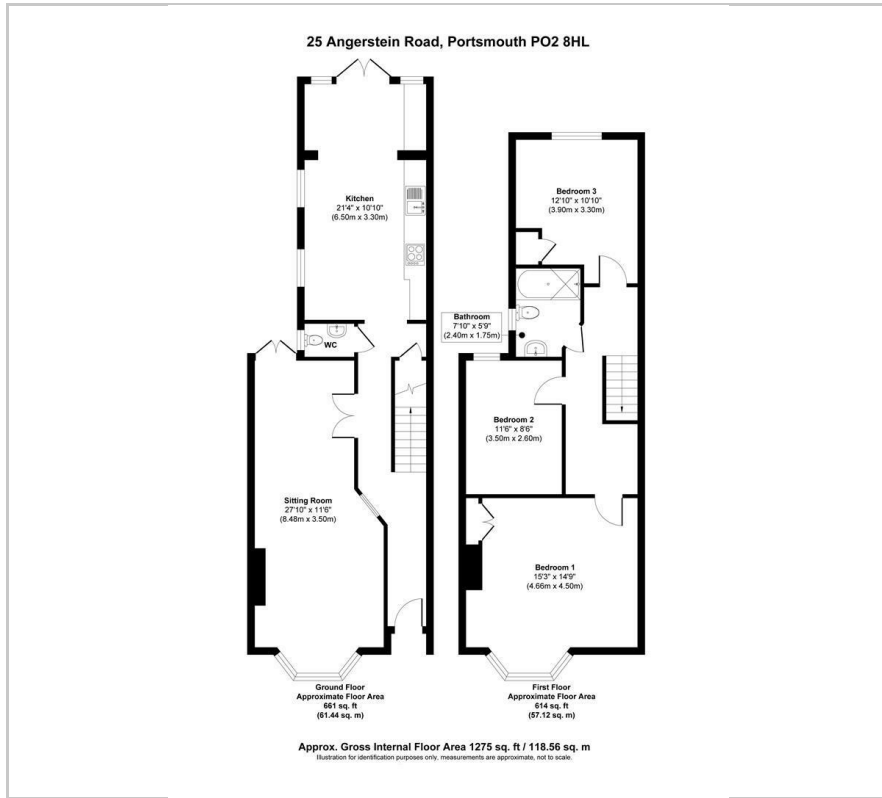

Area Map



Energy Efficiency Graph

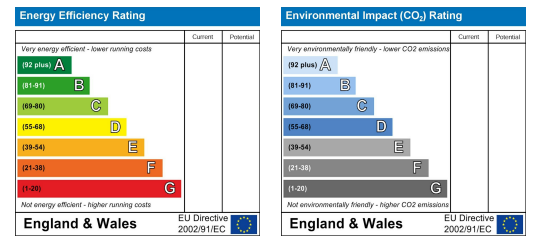

These particulars, whilst believed to be accurate are set out as a general outline only for guidance and do not constitute any part of an offer or contract. Intending purchasers should not rely on them as statements of representation of fact, but must satisfy themselves by inspection or otherwise as to their accuracy. No person in this firm's employment has the authority to make or give any representation or warranty in respect of the property.

120 Elm Grove, Hayling Island, Hampshire, PO11 9EH

Tel: 02392 460 899 Email: info@ardenway.co.uk www.ardenway.co.uk