

HUNTERS[®]

EXCLUSIVE

Mill Cottage, Buckden

Price £345,000

Property Images



HUNTERS[®]

EXCLUSIVE

Property Images



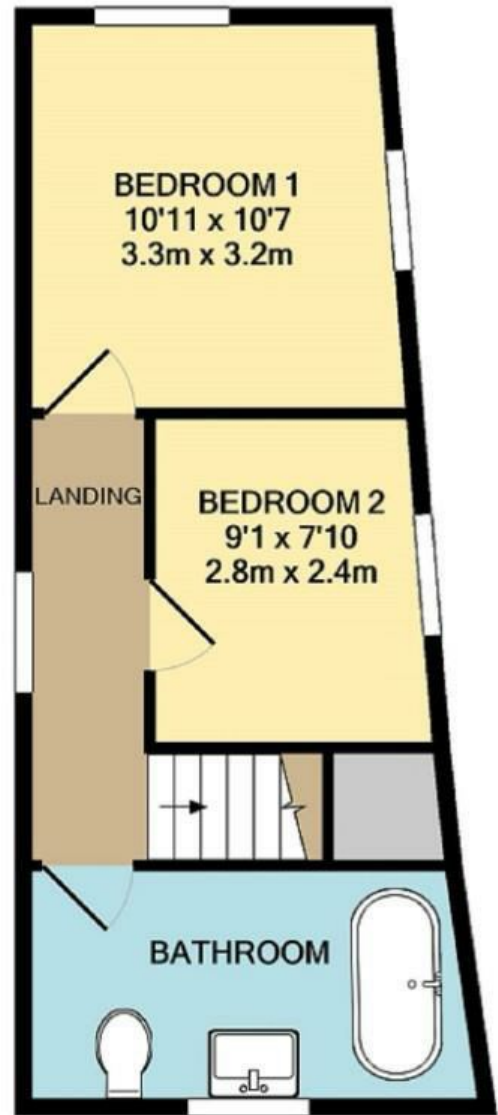
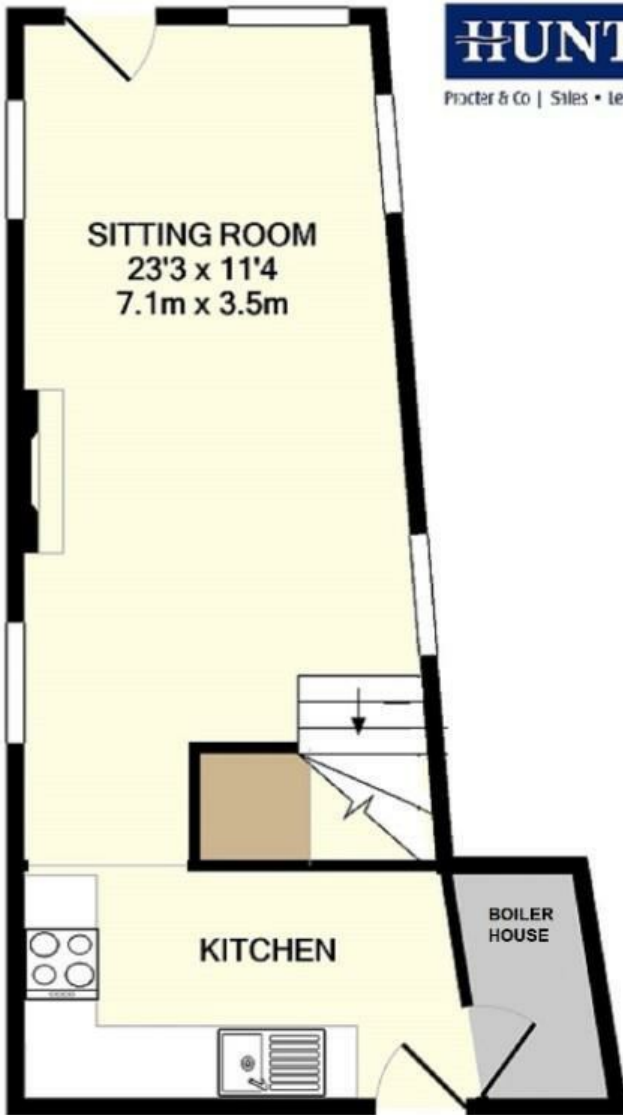

Whilst every attempt has been made to ensure the accuracy of the floor plan contained here, measurements of doors, windows, rooms and any other items are approximate and no responsibility is taken for any error, omission, or mis-statement. This plan is for illustrative purposes only and should be used as such by any prospective purchaser. The services, systems and appliances shown have not been tested and no guarantee as to their operability or efficiency can be given

Energy Efficiency Rating	
Current	Potential
	100
<i>Very energy efficient - lower running costs</i>	
(92 plus) A	
(81-91) B	
(69-80) C	
(55-68) D	55
(39-54) E	
(21-38) F	
(1-20) G	
<i>Not energy efficient - higher running costs</i>	
<small>EU Directive 2002/91/EC</small>	
England & Wales	



Nestled in the picturesque village of Buckden in the heart of the Yorkshire Dales National Park, this charming stone-built detached cottage is a true gem waiting to be discovered.

Once a saw mill, this delightful property has been beautifully renovated to offer a perfect blend of historic character and modern comforts. In the past a successful holiday cottage and more recently a longer term LET through this agency.

Set in a delightful location backing onto a beck and rolling fells. The village pub and shop are just a 2 minute stroll round the corner.

As you step inside, you are greeted by a cosy sitting room featuring a wood-burning stove, ideal for those chilly evenings. The cottage boasts original beams and exposed stonework, adding to its character and charm. Imagine relaxing on the patio, overlooking the tranquil stream that runs alongside the property - a peaceful retreat right at your doorstep.

This cottage is a haven for nature lovers and avid walkers, with a myriad of footpaths and circular walks to explore in the surrounding area. The nearby River Wharfe offers a serene setting for leisurely strolls. For those looking to venture further afield, Malham Tarn and Kettlewell are just a short drive away, while the bustling towns of Grassington and Skipton are within easy reach.

The property features two cosy bedrooms, including a double and a small double, ensuring a comfortable stay for residents or guests. The bathroom is equipped with a bath/shower combination, basin, and WC for convenience. The well-equipped kitchen boasts modern amenities such as an integrated dishwasher and washer/dryer, along with a double oven for culinary enthusiasts.

Don't miss the opportunity to make this enchanting cottage your own and experience the idyllic lifestyle it offers in the heart of the stunning Upper Wharfedale Valley. With a Dales bus service operating daily, convenience and tranquility await at this unique property in Buckden.

Two bedrooms: 1 x double, 1 x smaller double
Bathroom with bath/shower over, basin and WC
Well-equipped kitchen with integrated dishwasher and washer / dryer. Double oven & induction Hob
Sitting room with dining area, wood-burning stove and door out to rear patio
Oil fired central heating & Double glazed
Broadband available
Parking for 2 cars, additional roadside parking nearby
Small front garden and rear patio garden area overlooking the beck
Council Tax Band D

On-Line-Bullet-Points

- A unique and charming Dales Cottage
- Refurbished yet retaining period charm
- Beautiful village, great location
- Some lovely views
- Parking and garden area
- 2 double bedrooms, modern bathroom
- Modern kitchen with appliances
- Spacious living room with wood-burner and door onto rear
- Pub and Village Store 100 metres away
- Dales Bus Service close by