

HUNTERS[®]

HERE TO GET *you* THERE



Litton, BD23 5QJ

£1,650 Per Month



Location...location...location...

A charming and cosy 3 bed cottage set in a delightful location in the village of Litton. Litton is 1.5 miles up from Arncliffe, both famous for their scenes from the current BBC series All Creatures Great & Small. The larger village / Town of Grassington is just 10 miles away and the well connected Market Town of Skipton is a round a 30 minute drive, and Settle about 25 minutes 'over the tops'.

The highly regarded Queens Arms has earned an excellent reputation for food and drink, especially its homemade pies, and is literally next door.

Having a living room with wood-burning-stove, sitting room with real fire and a separate dining room, this is a family sized cottage, all with a delightful outlook across The Dales.

Ready for immediate occupation April 2024



Area Map



Floor Plans

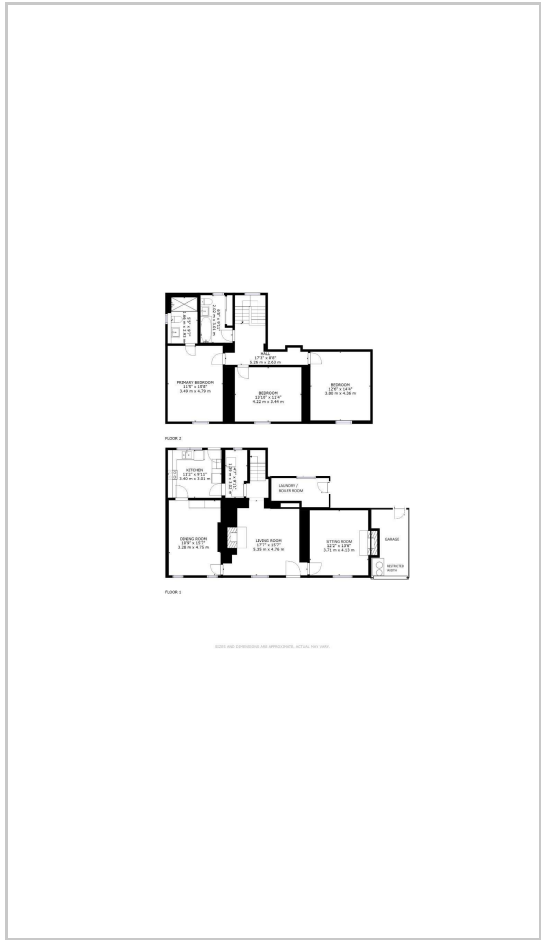

Energy Efficiency Graph

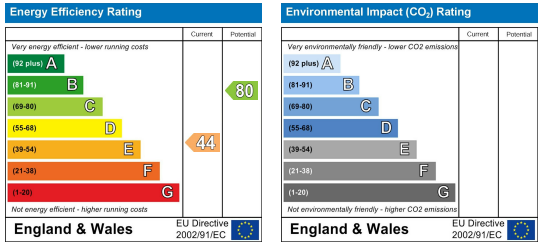

These particulars are intended to give a fair and reliable description of the property but no responsibility for any inaccuracy or error can be accepted and do not constitute an offer or contract. We have not tested any services or appliances (including central heating if fitted) referred to in these particulars and the purchasers are advised to satisfy themselves as to the working order and condition. If a property is unoccupied at any time there may be reconnection charges for any switched off/disconnected or drained services or appliances - All measurements are approximate. **THINKING OF SELLING?** If you are thinking of selling your home or just curious to discover the value of your property, Hunters would be pleased to provide free, no obligation sales and marketing advice. Even if your home is outside the area covered by our local offices we can arrange a Market Appraisal through our national network of Hunters estate agents.