



colin ellis
your trusted property experts

Westbourne Grove, Scarborough, YO11 2DL

Located in the South Cliff area of Scarborough this first floor studio flat comes with bedroom/lounge/kitchen and bathroom. Conveniently located for local shops and the town centre this flat is available for immediate occupation. Viewing is highly recommended. Rent includes WiFi.

Rent - £425 Per Month
Deposit - £490



LIVING AREA
 4.588 x 3.830 (15'0" x 12'6")

KITCHEN

BATHROOM
 1.401 x 1.151 (4'7" x 3'9")



FIRST FLOOR
 385 sq.ft. (35.7 sq.m.) approx.

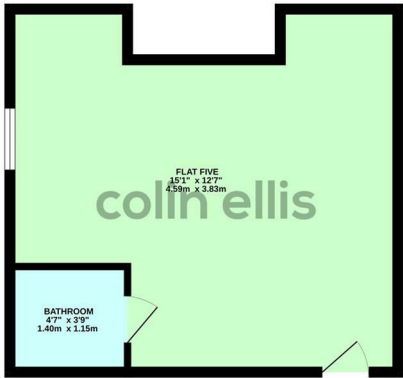

TOTAL FLOOR AREA - 385 sq.ft. (35.7 sq.m.) approx.
 While every attempt has been made to ensure the accuracy of the figures contained here, measurements of areas, volumes, distances, etc. may vary from the actual dimensions and measurements of the property. The figures are for information only and should not be used as a basis for any legal proceedings. The figures are for information only and should not be used as a basis for any legal proceedings.

Westbourne Grove - 18675358
Council Tax Band - A
Length of Tenancy - Please contact office for further information

DISCLAIMER: The agent has not tested any apparatus, fittings or services and so cannot verify they are in working order. The buyer is advised to obtain verification from their own solicitor or surveyor. Occasionally a wide angle lens may be used. This property was inspected by COLIN ELLIS PROPERTY SERVICES. We always try to make our sales particulars accurate and reliable, but if there is any point which is of particular importance to you, especially if you are considering travelling some distance to view the property, please do not hesitate to contact this office, we will be pleased to check the information for you. Council Tax Band ratings have been provided by DirectGov.

