



**colin ellis**  
your trusted property experts

**Ramshill Road,  
Scarborough, YO11 2LN**

Located in the South Cliff area of Scarborough this studio flat comes with bedroom/living room, kitchen and shower room. Conveniently located for local shops and the town centre this flat is available for immediate occupation. This building benefits from an on site laundrette. Viewing is highly recommended. PLEASE NOTE THIS FLAT IS TOP FLOOR AND HAS NO LIFT.

**Rent - £395 PCM  
Deposit - £450**





**ENTRANCE HALL**

**LIVING ROOM/BEDROOM**  
 3.66 x 3.26 (12'0" x 10'8")  
 Murphy bed.

**KITCHEN**  
 2.65 x 1.18 (8'8" x 3'10")

**BATHROOM**  
 2.65 x 1.13 (8'8" x 3'8")



THIRD FLOOR  
 237 sq.ft. (22.0 sq.m.) approx.

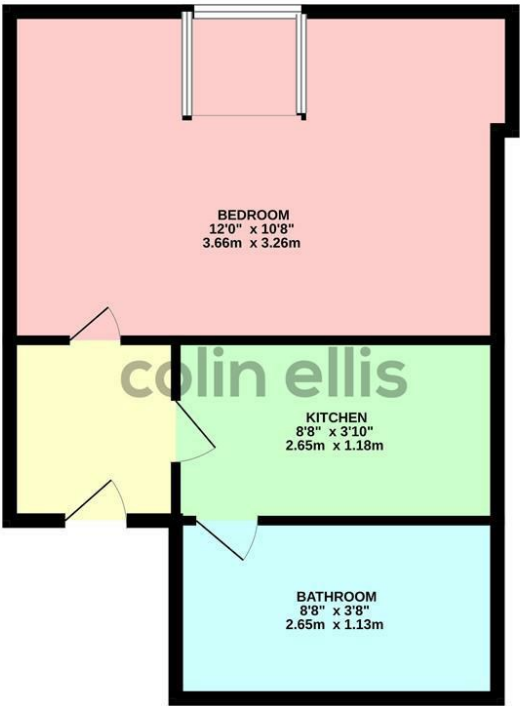

TOTAL FLOOR AREA : 237 sq.ft. (22.0 sq.m.) approx.  
Whilst every attempt has been made to ensure the accuracy of the floorplan contained here, measurements of doors, windows, rooms and any other items are approximate and no responsibility is taken for any error, omission or mis-statement. This plan is for illustrative purposes only and should be used as such by any prospective purchaser. The services, systems and appliances shown have not been tested and no guarantee as to their operability or efficiency can be given.  
 Made with Metropac C2025

**Ramshill Road - 18669754**  
**Council Tax Band - A**  
**Length of Tenancy - Please contact office for further information**

DISCLAIMER: The agent has not tested any apparatus, fittings or services and so cannot verify they are in working order. The buyer is advised to obtain verification from their own solicitor or surveyor. Occasionally a wide angle lens may be used. This property was inspected by COLIN ELLIS PROPERTY SERVICES. We always try to make our sales particulars accurate and reliable, but if there is any point which is of particular importance to you, especially if you are considering travelling some distance to view the property, please do not hesitate to contact this office, we will be pleased to check the information for you.

Council Tax Band ratings have been provided by DirectGov.

