

colin ellis
your trusted property experts

St Martins Square, Scarborough, YO11 2DQ

This one bedroom top floor flat located in the sought after South Cliff area benefits from an open plan lounge/kitchen, large bedroom and three piece bathroom suite.

Rent - £450 PCM
Deposit - £500

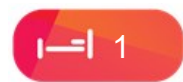

HALLWAY

LOUNGE/KITCHEN/DINER

4.4 x 4.8 (14'5" x 15'9")

BEDROOM

3.8 x 4.2 (12'6" x 13'9")

BATHROOM

2.1 x 1.4 (6'10" x 4'7")



THIRD FLOOR

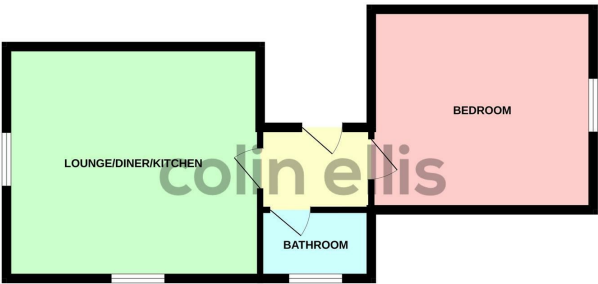

Whilst every attempt has been made to ensure the accuracy of the floorplan contained here, measurements of plots, windows, doors and any other items are approximate and no responsibility is taken for any error, omission or mis-statement. This plan is for illustrative purposes only and should be used as such by any prospective purchaser. The services, fixtures and appliances shown have not been tested and no guarantee as to their operating or efficiency can be given.
Made with floorplan 12025



St Martins Square - 18021153
Council Tax Band - A
Length of Tenancy - Please contact office for further information

DISCLAIMER: The agent has not tested any apparatus, fittings or services and so cannot verify they are in working order. The buyer is advised to obtain verification from their own solicitor or surveyor. Occasionally a wide angle lens may be used. This property was inspected by COLIN ELLIS PROPERTY SERVICES. We always try to make our sales particulars accurate and reliable, but if there is any point which is of particular importance to you, especially if you are considering travelling some distance to view the property, please do not hesitate to contact this office, we will be pleased to check the information for you.
Council Tax Band ratings have been provided by DirectGov.

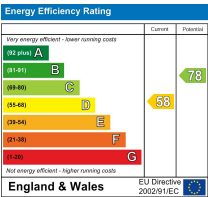

Tel: 01723 363565
E-mail: info@colinellis.co.uk



RESIDENTIAL & COMMERCIAL SALES
LETTINGS CHARTERED SURVEYOR

See all our properties online
www.colinellis.co.uk