



colin ellis

Ireton Street, Scarborough, YO12 7DR

Located centrally for Scarborough town centre this three bedroom end terraced home is offered to the market with no onward chain. Benefitting from a new roof, new windows and gas central heating this home is ready to move into and comes with a large rear yard. Viewing is highly recommended.

Guide Price £146,950

3

1

2

E

VESTIBULE

Coving, dado rail and uPVC double glazed door.

ENTRANCE HALL

Coving, dado rail, radiator and stairs to first floor.

DINING ROOM

3.55 x 2.97 (11'7" x 9'8")

Dado rail, picture rail, coving, radiator, under stairs storage cupboard, alcove storage cupboard housing boiler and uPVC double glazed window.

LOUNGE

2.97 x 3.78 (9'8" x 12'4")

Coving, uPVC double glazed bay window, radiator, gas fire and surround, picture and dado rail.

KITCHEN

3.20 x 1.96 (10'5" x 6'5")

Fitted kitchen with a range of cupboards and drawers, extractor fan, space for oven, space for washing machine, space for fridge/freezer, uPVC double glazed window and frosted door into rear yard, and radiator.

REAR YARD

Two storage cupboards with electric.

FIRST FLOOR LANDING

Dado rail and radiator.

BEDROOM ONE

3.70 x 3.14 (12'1" x 10'3")

Fitted wardrobe, uPVC double glazed window, and radiator



BATHROOM

2.30 x 3.54 (7'6" x 11'7")

Corner bath, wc, hand basin, electric shower, wet walling, coving, radiator and uPVC double glazed frosted window.

SECOND FLOOR LANDING

Dato rail, loft access and skylight.

BEDROOM TWO

3.66 x 2.79 (12'0" x 9'1")

Sky light and radiator.

BEDROOM THREE

1.94 x 3.18 (6'4" x 10'5")

Sky light and radiator.



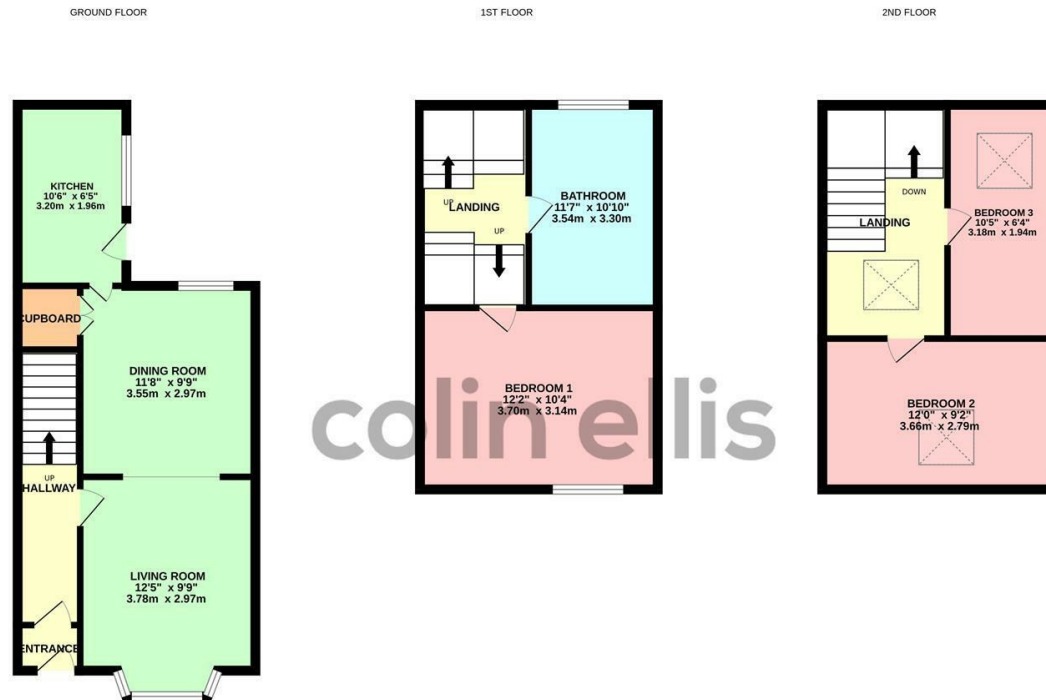

Whilst every attempt has been made to ensure the accuracy of the floorplan contained here, measurements of doors, windows, rooms and any other items are approximate and no responsibility is taken for any error, omission or mis-statement. This plan is for illustrative purposes only and should be used as such by any prospective purchaser. The services, systems and appliances shown have not been tested and no guarantee as to their operability or efficiency can be given.
Made with Metropix ©2024

Ireton Street - 18678835
Council Tax Band - A
Tenure - Freehold

DISCLAIMER: The agent has not tested any apparatus, fittings or services and so cannot verify they are in working order. The buyer is advised to obtain verification from their own solicitor or surveyor. Occasionally a wide angle lens may be used. This property was inspected by COLIN ELLIS PROPERTY SERVICES. We always try to make our sales particulars accurate and reliable, but if there is any point which is of particular importance to you, especially if you are considering travelling some distance to view the property, please do not hesitate to contact this office, we will be pleased to check the information for you. Council Tax Band ratings have been provided by DirectGov.

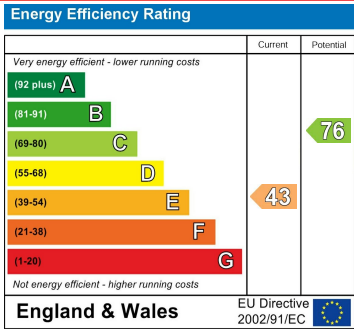

Tel: 01723 363565
E-mail: info@colinellis.co.uk

RESIDENTIAL & COMMERCIAL SALES
LETTINGS CHARTERED SURVEYOR

See all our properties online
www.colinellis.co.uk