

Situated in a highly sought after location and rarely available is this very well presented three bedroom detached bungalow benefitting from no forward chain, the property briefly comprises spacious lounge/ diner, extended kitchen/ breakfast room, a good size rear garden & ample off road parking with garage to the front.

The Accommodation Comprises:

UPVC double glazed doors to:

Entrance Porch

UPVC double glazed door with side panel to:

Entrance Hall

Radiator, access to loft via hatch, storage cupboard with shelves, cupboard housing utility meters.

Shower Room 5' 3" x 8' 5" (1.60m x 2.56m)

Two UPVC double glazed windows to side elevation, vanity unit to wall, double shower cubicle with shower above, low level WC, wash hand basin set in vanity unit, lino flooring, inset spotlights.

Kitchen 11' 6" x 9' 9" (3.50m x 2.97m)

UPVC double glazed window to side elevation, Baxi boiler to wall, range of base cupboards and matching eye level units, integrated oven and grill, gas hob with extractor hood over, tiled flooring, space for fridge/freezer, space and plumbing for: washing machine, dishwasher, tumble dryer.

Sun Room 9' 4" x 8' 9" (2.84m x 2.66m)

UPVC double glazed window and door to rear elevation, obscured window to left hand side, additional UPVC window looking into the dining room, radiator, tiled flooring, polycarbonate roof.

Lounge/Diner 26' 11" x 12' 7" (8.20m x 3.83m)

Two UPVC double glazed windows to side elevation, plus UPVC double glazed door and window overlooking the garden, two radiators, fireplace with electric fire.

Bedroom One 10' 2" x 13' 2" (3.10m x 4.01m)

UPVC double glazed window to front elevation, radiator, wardrobes with mirror fronted sliding doors.

Bedroom Two 12' 1" x 9' 2" (3.68m x 2.79m)

UPVC double glazed window to front elevation, radiator, wardrobes to side and over bed.

Bedroom Three 7' 1" x 10' 0" (2.16m x 3.05m)

UPVC double glazed window to side elevation, radiator, fitted wardrobes.

Outside

To the front of the property is a block paved drive providing ample parking, low brick wall, side gate to rear garden and access to garage with up and over door, light and power. The rear garden is a good size, mainly laid to lawn with patio and path enclosed by panelled fencing, shed and summer house.

General Information

Construction: Traditional

Water Supply: Portsmouth Water

Electric Supply: TBC

Sewerage: Mains sewerage

For Mobile & Broadband coverage: <https://checker.ofcom.org.uk>

For Flood risk: <https://www.gov.uk/check-long-term-flood-risk>



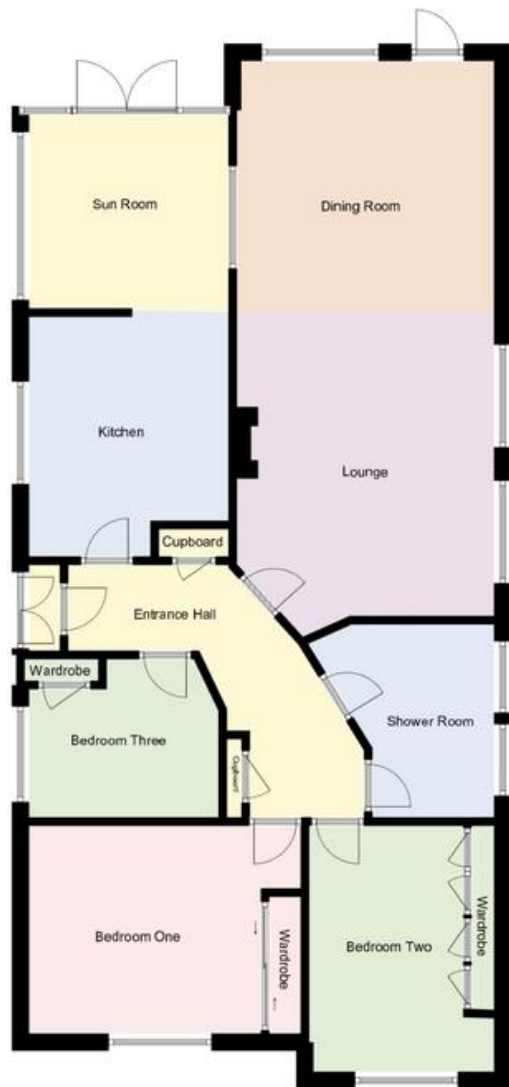

Awaiting EPC

Tenure: Freehold
Council Tax Band: D

Disclaimer: These particulars are set out as a general outline in accordance with the Consumer Protection from Unfair Trading Regulations 2008 (CPR's) and Business Protection from Misleading Marketing Regulations 2008 (BPR's) only for the guidance of intending purchasers or lessees, and do not constitute any part of an offer or contract. Details are given without any responsibility, and any intending purchasers, lessees or third parties should not rely on them as statements or representations of fact, but must satisfy themselves by inspection or otherwise as to the correctness of each of them.

We have not carried out a structural survey and the services, appliances and specific fittings have not been tested. All photographs, measurements, floor plans and distances referred to are given as a guide only and should not be relied upon for the purchase of carpets or any other fixtures or fittings. Gardens, roof terraces, balconies and communal gardens as well as tenure and lease details cannot have their accuracy guaranteed for intending purchasers. Lease details, service ground rent (where applicable) are given as a guide only and should be checked and confirmed by your solicitor prior to exchange of contracts.

No person in the employment of Fenwicks Estates Ltd has any authority to make any representation or warranty whatever in relation to this property. Purchase prices, rents or other prices quoted are correct at the date of publication and, unless otherwise stated, exclusive of VAT.

Data Protection: We retain the copyright in all advertising material used to market this Property.

Money Laundering Regulations 2017: Intending purchasers will be required to produce identification documentation once an offer is accepted.



DRAFT DETAILS

£425,000
Stradbrook, Gosport, PO13 0EZ

Fenwicks - Gosport Office: 02392 529889 www.fenwicks-estates.co.uk

Fenwicks
THE INDEPENDENT ESTATE AGENT