

This ground floor two bedroom retirement apartment is situated in the popular Pearce Court within Gosport. The apartment on offer benefits from direct access to the communal gardens.

The Accommodation Comprises:-

Glazed front door to:

Entrance Hallway:-

Wall heater, cupboard housing tank.

Lounge/Diner:- 18' 1" x 9' 10" (5.51m x 2.99m) maximum measurements

UPVC double glazed window and door to communal garden, wall mounted heater, emergency pull cord.

Kitchen:- 9' 7" x 7' 9" (2.92m x 2.36m) maximum measurements

UPVC double glazed window to front elevation, base and eye level units, space and plumbing for washing machine, space for fridge and freezer, sink unit, emergency pull cord.

Bedroom One:- 11' 0" x 6' 3" (3.35m x 1.90m) maximum measurements

UPVC double glazed window to rear elevation, fitted wardrobes and bedside cabinets, emergency pull cord.

Bedroom Two:- 9' 8" x 7' 3" (2.94m x 2.21m) maximum measurements

UPVC double glazed window to front elevation, emergency pull cord.

Shower Room:- 6' 11" x 5' 7" (2.11m x 1.70m) maximum measurements

Low level W.C, double shower, wash hand basin set in vanity unit.

Communal Facilities:-

Residents parking, communal garden, utility room, guest suite available for hire, residents meeting area.

Agents Notes:-

The vendor informs us at the time of instruction of the following lease information. We would however suggest this information is verified by your legal representative before exchange of contracts.

Lease: Approx 70 Years Remaining.

Ground Rent: Included in Service Charge

Service Charge: £3786.60 Per Annum

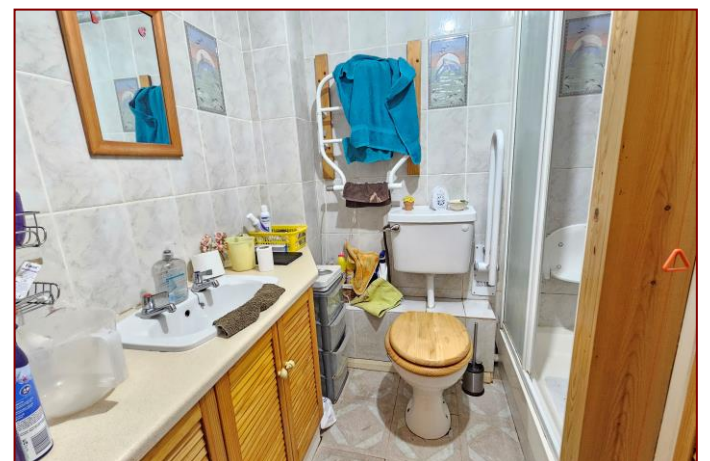

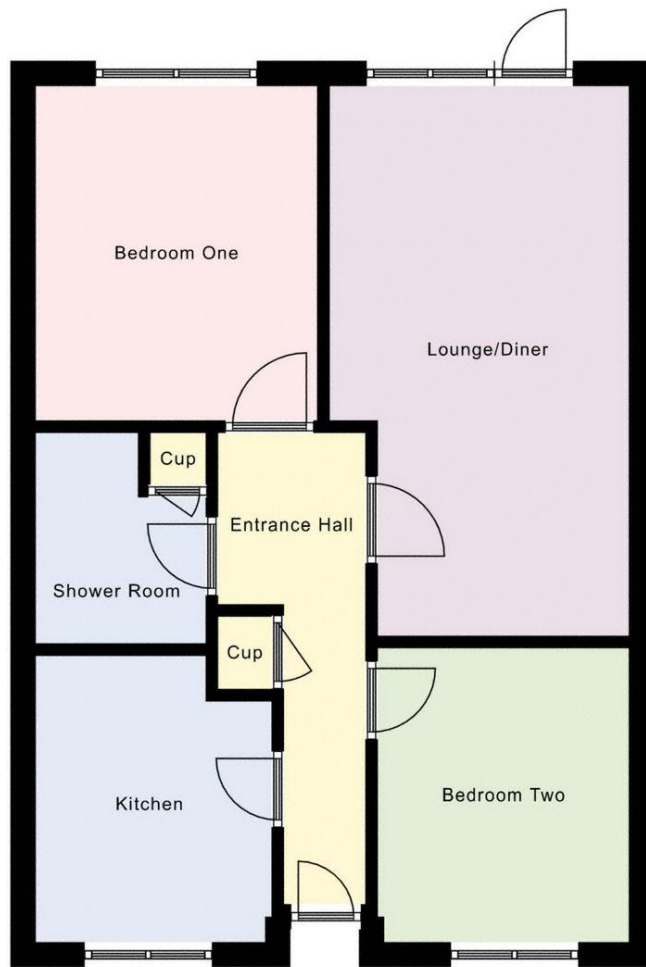

Tenure: Share of Freehold

Council Tax Band: A

Score	Energy rating	Current	Potential
92+	A		
81-91	B		
69-80	C	69 C	79 C
55-68	D		
39-54	E		
21-38	F		
1-20	G		

Disclaimer: These particulars are set out as a general outline in accordance with the Consumer Protection from Unfair Trading Regulations 2008 (CPR's) and Business Protection from Misleading Marketing Regulations 2008 (BPR's) only for the guidance of intending purchasers or lessees, and do not constitute any part of an offer or contract. Details are given without any responsibility, and any intending purchasers, lessees or third parties should not rely on them as statements or representations of fact, but must satisfy themselves by inspection or otherwise as to the correctness of each of them.

We have not carried out a structural survey and the services, appliances and specific fittings have not been tested. All photographs, measurements, floor plans and distances referred to are given as a guide only and should not be relied upon for the purchase of carpets or any other fixtures or fittings. Gardens, roof terraces, balconies and communal gardens as well as tenure and lease details cannot have their accuracy guaranteed for intending purchasers. Lease details, service ground rent (where applicable) are given as a guide only and should be checked and confirmed by your solicitor prior to exchange of contracts.

No person in the employment of Fenwicks Estates Ltd has any authority to make any representation or warranty whatever in relation to this property. Purchase prices, rents or other prices quoted are correct at the date of publication and, unless otherwise stated, exclusive of VAT.

Data Protection: We retain the copyright in all advertising material used to market this Property.

Money Laundering Regulations 2017: Intending purchasers will be required to produce identification documentation once an offer is accepted.



£110,000

5 Pearce Court, George Street, Gosport, PO12 4SZ

DRAFT DETAILS

Fenwicks - Gosport Office: 02392 529889 www.fenwicks-estates.co.uk

Fenwicks

THE INDEPENDENT ESTATE AGENT