



**HENDERSON
CONNELLAN**
ESTATE AGENTS

Wentworth Drive, Corby, Northamptonshire, NN17 5AQ

£169,950

🛏️ 2 🚿 1 🚻 1



"Enjoy Elevated Living!"

This first floor apartment is well located within Priors Hall Park and offers a well presented interior. The accommodation comprises a central hall, open plan living/dining room, smart fitted kitchen, there is a main bathroom and two double sized bedrooms with an en-suite shower room to the master. Outside there is allocated parking.

Description:

This first floor apartment is located within Priors Hall Park which is a well service community offering amenities such as a Sainsbury's Local, café/coffee shop, vets , other retailers, schools and dedicated outdoors spaces for the residents.

The apartment is offered for sale with a well presented interior and a well thought out floorplan.

The accommodation includes an airy central hall which benefits from cloak storage cupboard.

The living/dining room is dual aspect and leads to the kitchen which is fitted with a range of wall and base level units with work surfaces incorporating a sink with drainer and mixer tap. There is a built in electric fan assisted oven, gas hob and an extractor hood. There is also an integrated dish washer, fridge, freezer and a washing machine.

There are two double sized bedrooms with the main bedroom benefitting from a built in wardrobe and a shower room en-suite which includes a shower enclosure, WC and a pedestal wash hand basin with ceramic tiled wall surrounds.

The main bathroom includes a side panel bath with a shower and screen, WC and a pedestal wash hand basin with ceramic tiled wall surrounds.

Outside:

There is an allocated parking space included.

Room Measurements:

Living/Dining Room 4.27m x 3.96m (14'0" x 13'0")

Kitchen 3.96m x 1.96m (13'0" x 6'5")

Bathroom 2.26m x 1.91m (7'5" x 6'3")

Bedroom One 3.35m x 2.87m (11'0" x 9'5")

Shower En-suite 2.01m x 1.83m (6'7" x 6'0")

Bedroom Two 3.3m x 2.39m (10'10" x 7'10")



Ground Floor

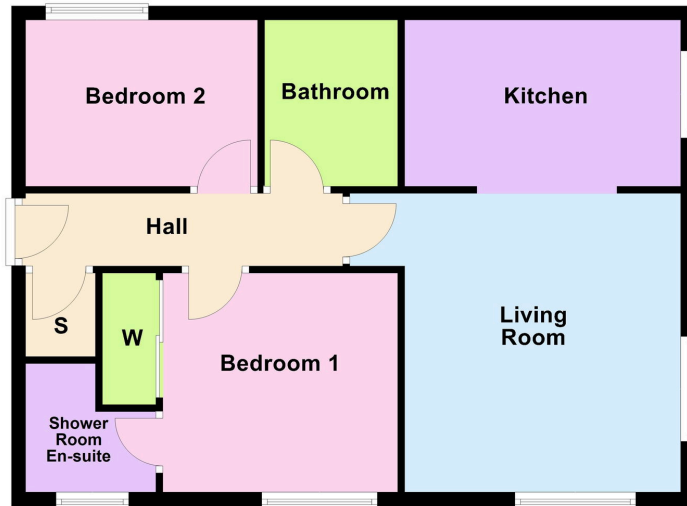

- First Floor Modern Apartment • Two Double Bedrooms
- Shower Room En-Suite
- Main Bathroom
- Open Plan Living/Dining Room
- Smart Fitted Kitchen
- Well Presented Interior
- Allocated Parking Space



Disclaimer: These particulars do not form part of any offer or contract and should not be relied upon as statements or representations of fact. Any areas, measurements or distances are approximate. The text, photographs and plans are for guidance only and are not necessarily comprehensive.

10 Spencer Court, Corby,
Northamptonshire, NN17 1NU

