



**HENDERSON
CONNELLAN**
ESTATE AGENTS

Cupar Crescent, Corby, Northamptonshire

£200,000

3 1 1



"Town Centre Location"

This established end of terrace family home is centrally located within Corby and is being offered for sale with NO CHAIN. The much improved accommodation comprises welcoming entrance hall, living/dining room and there is a re-fitted fitted kitchen/breakfast room. From the first floor landing there is a shower room, separate WC and three generously sized bedrooms. There is a neatly maintained front garden and an enclosed rear garden.

Full Description

Beautifully presented end of terrace family home located close to Corby Town Centre and all of the amenities.

The property offers well proportioned living accommodation and is being sold with no upward chain.

Welcoming entrance hall with the stairs rising to the first floor landing and useful cloaks cupboard.

Generously sized living/dining room with a feature fireplace.

Re-fitted kitchen/breakfast room with a range of eye and base level units with roll top work surfaces incorporating a single drainer sink with mixer tap, gas hob with extractor hood above, fitted eyeline oven, space and plumbing for a washing machine, space for a fridge/freezer, breakfast bar and ceramic tiled splash backs.

On the first floor there are three well proportioned bedrooms.

Shower room fitted with a walk in shower, wash hand basin set on a vanity style unit and ceramic tiled splash backs.

Separate WC.

Further benefits include gas radiator heating and UPVC double glazed windows.

Outside

The property offers a neat lawn to the front and a rear garden with a paved patio seating area accompanied by the main lawn, floral borders and fully enclosed by timber panel fencing and brick walls.



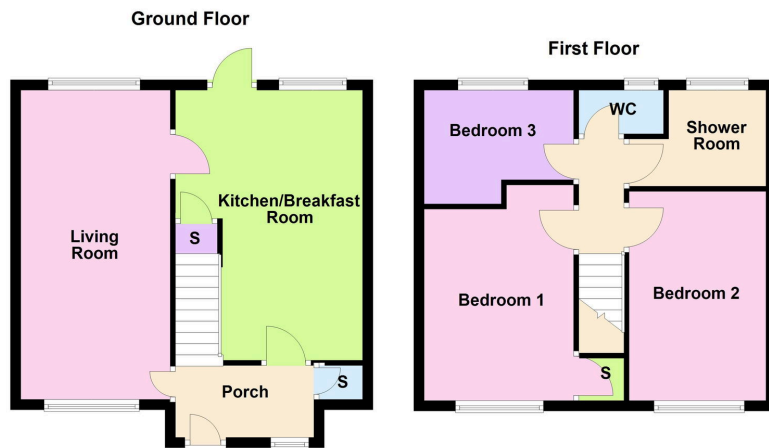

- Living Room 5.99m x 2.9m (19'8" x 9'6")
- Kitchen 5.08m x 3.63m (16'8" x 11'11")
- Bedroom One 3.71m x 3.23m (12'2" x 10'7")
- Bedroom Two 4.19m x 2.49m (13'9" x 8'2")
- Bedroom Three 3.07m x 2.18m (10'1" x 7'2")
- Shower Room 1.7m x 1.65m (5'7" x 5'5")
- WC 1.68m x 0.84m (5'6" x 2'9")



Disclaimer: These particulars do not form part of any offer or contract and should not be relied upon as statements or representations of fact. Any areas, measurements of distances are approximate. The text, photographs and plans are for guidance only and are not necessarily comprehensive.

10 Spencer Court, Corby,
Northamptonshire, NN17 1NU

