



**HENDERSON  
CONNELLAN**  
ESTATE AGENTS

Hoy Walk, Corby, NN17 2RA

£175,000

🛏️ 2 🚿 1 🚗 0



## "In Fine Form"

Located within the Lodge Park area, this terrace property comes with parking and a single garage which is accessible from the rear elevation. The accommodation comprises entrance hall, living room, kitchen/diner. Upstairs there are two double sized bedrooms, a shower room, and a separate WC. The rear garden is enclosed and laid to lawn with a timber deck.

This property is well located within Lodge Park.

The accommodation comprises entrance hall with stairs rising to the first floor and there is a useful storage cupboard.

The living room is rear facing.

The kitchen/Diner is dual aspect with a patio doors opening onto the rear garden. There is a fitted range of wall and base level units with work surfaces incorporating a sink with drainer and mixer tap with ceramic tiled wall surrounds and floor.

From the first floor landing there is a storage cupboard, airing cupboard, shower room and a separate WC.

Two double sized bedrooms.

Outside the property enjoys a pleasant enclosed rear garden which is mainly laid to lawn and there is a timber deck. There is a single brick built garage which can be accessed from the rear with parking in front.



- Living Room 3.81m x 3.45m (12'6" x 11'4")
- Kitchen/Diner 5.36m x 3.2m (17'7" x 10'6")
- Bedroom One 3.81m x 3.53m (12'6" x 11'7") Max
- Bedroom Two 3.81m x 3.53m (12'6" x 11'7") Max
- Shower Room 1.75m x 1.57m (5'9" x 5'2")

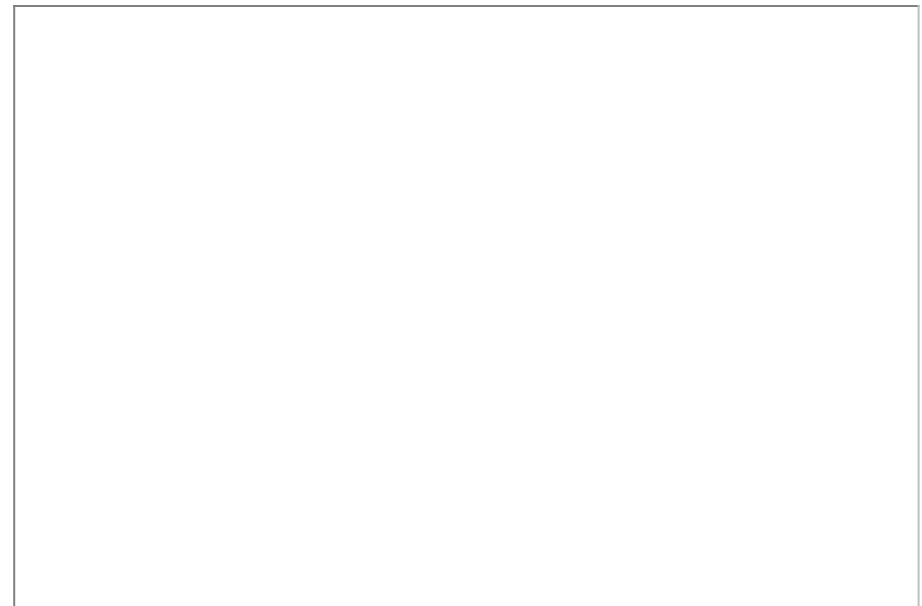
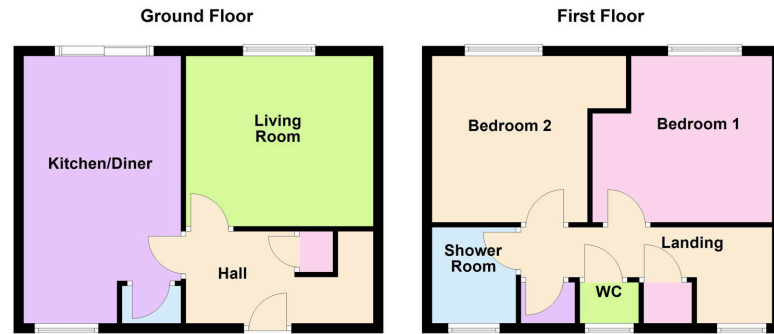

Disclaimer: These particulars do not form part of any offer or contract and should not be relied upon as statements or representations of fact. Any areas, measurements of distances are approximate. The text, photographs and plans are for guidance only and are not necessarily comprehensive.

10 Spencer Court, Corby,  
Northamptonshire, NN17 1NU

