



**HENDERSON
CONNELLAN**
ESTATE AGENTS

Gainsborough Road, Corby, Northamptonshire

£175,000

3 1 1



"Ready For Change"

This well positioned terrace house is located towards Colder Meadow Avenue and is situated opposite a pleasant wooded area. This property offers the next owner the opportunity to update and style the interior in their own way and is being offered for sale with NO CHAIN. The accommodation comprises entrance hall, utility, kitchen and a living/dining room. Upstairs there are three bedrooms, bathroom and a separate WC. Outside there is a retained front garden and a good sized enclosed garden to the rear. A great project property which will make a lovely home.

Properties like this towards the top end of Gainsborough Road rarely become available and this terrace home is being offered for sale with NO CHAIN and requires some general updating.

The accommodation includes an entrance hall with stairs rising to the first floor landing.

There is a utility room which also features a front doors and there is an under stairs storage cupboard.

The living/dining room is dual aspect.

The kitchen is fitted with a range of units with work surfaces incorporating a sink with drainer with mixer tap and ceramic tiled wall surrounds. A door leads onto the rear garden.

From the first floor landing there is an airing cupboard, there is a bathroom including a side panel bath and pedestal wash hand basin with ceramic tiled wall surrounds and a separate WC.

There are three double sized bedrooms.

The property benefits from a gas fired central heating system.

Outside the plot is well maintained providing a retained front garden with a neat lawn and path. The rear garden is a good size and is mainly laid to lawn, there is a useful timber storage shed.



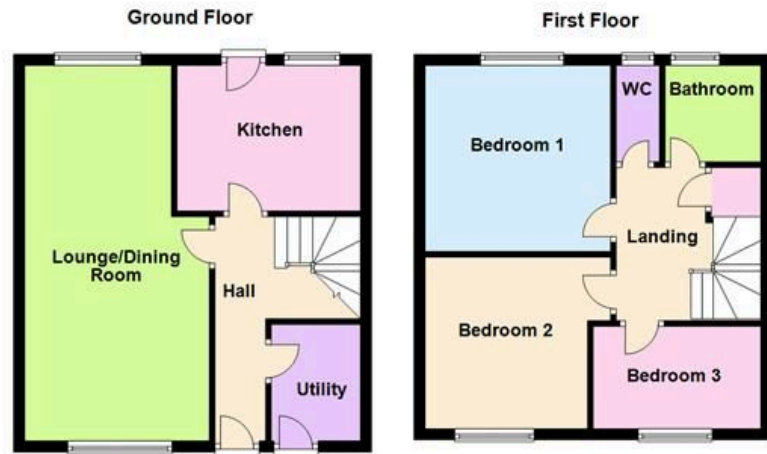

- Living/Dining Room 6.58m x 3.33m (21'7" x 10'11") max
- Kitchen 3.33m x 2.57m (10'11" x 8'5")
- Utility Room 1.96m x 1.65m (6'5" x 5'5")
- Bedroom One 3.66m x 3.43m (12'0" x 11'3")
- Bedroom Two 3.1m x 3.1m (10'2" x 10'2")
- Bedroom Three 3.18m x 2.06m (10'5" x 6'9")
- Bathroom 1.65m x 1.52m (5'5" x 5'0")

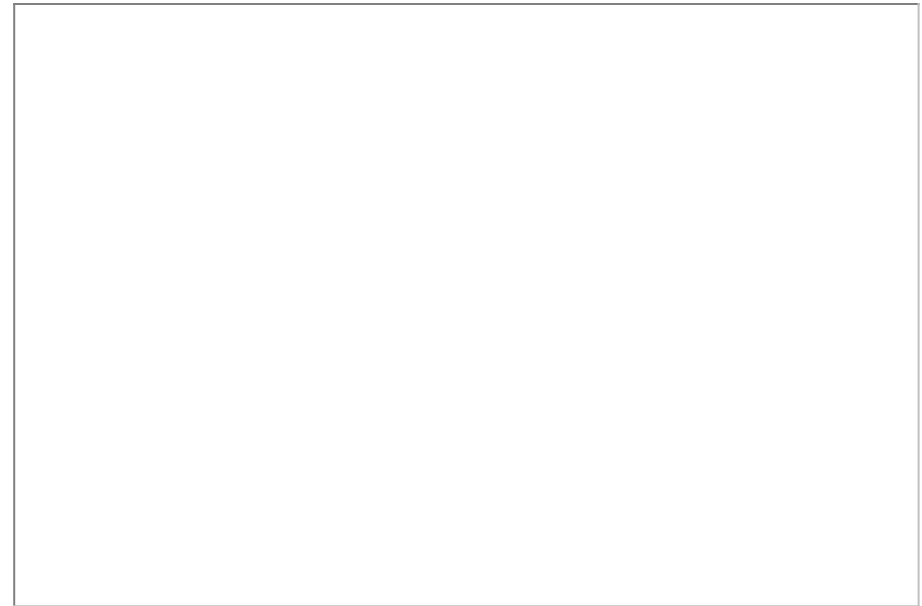

Disclaimer: These particulars do not form part of any offer or contract and should not be relied upon as statements or representations of fact. Any areas, measurements of distances are approximate. The text, photographs and plans are for guidance only and are not necessarily comprehensive.

10 Spencer Court, Corby,
Northamptonshire, NN17 1NU

