



**15 Field Terrace Road  
Newmarket, CB8 0AD  
£210,000**



## 15 Field Terrace Road, Newmarket, CB8 0AD

A charming Victorian cottage set on the outskirts of the town centre and located in a cluster of similar properties.

Boasting accommodation to include living room, refitted kitchen/breakfast room, bathroom, two good size bedrooms.

Externally the property offers a fully enclosed courtyard style garden and useful outbuilding/storage.

### **Living Room 11'11" x 11'5" (3.65m x 3.50m)**

With feature brick built fire place. Bay fronted window with storage under. Radiator.

### **Kitchen 11'11" x 10'0" (3.65m x 3.07)**

Fitted with a range of matching eye and base level storage units with work top surfaces over. Stainless steel sink and drainer with mixer tap over. Tiled splashbacks. Integrated oven with inset hob and extractor fan over. Stairs rising to first floor. Window to rear aspect.

### **Bathroom**

Fitted with a three piece suite comprising low level WC, hand basin and panelled bath with shower over. Heated towel rail. Window to side aspect.

### **Bedroom 1 11'11" x 9'11" (3.65m x 3.04m)**

With window to front aspect. Radiator.

### **Bedroom 2 9'11" x 9'0" (3.04m x 2.75m)**

With window to rear aspect. Radiator.

### **Outside - Rear**

Fully enclose rear courtyard benefitting from a useful outhouse.

### **Outside - Front**

Gated front courtyard with paved path leading to front door.

### **Location**

Newmarket, Suffolk, is a historic market town renowned for its horse racing heritage, being home to the famous Newmarket Racecourse. The town offers a blend of amenities, including shops, restaurants, and cafes, community theatre/cinema, as well as parks and recreational facilities. Key attractions include the National Horseracing Museum and various race-related events. In terms of distance to other cities, Newmarket is approximately 15 miles northeast of Cambridge, about 15 miles from Bury St Edmunds, and roughly 40 miles from Ipswich. Newmarket train station offers an hourly service in to Cambridge City in 25 minutes, with onwards links in to London, making it accessible for commuters and visitors alike.

### **Property Details**

EPC - D

Tenure - Freehold

Council Tax Band - A

Property Type - Terraced House

Property Construction – Standard

Number & Types of Room – Please refer to the floorplan

Parking – On Street

Electric Supply - Mains

Water Supply – Mains

Sewerage - Mains

Heating sources - Gas

Broadband Connected - TBC

Broadband Type – Ultrafast available, 1800Mbps download, 220Mbps upload

Mobile Signal/Coverage – Ofcom advise good on all networks

Rights of Way, Easements, Covenants – None that the vendor is aware of



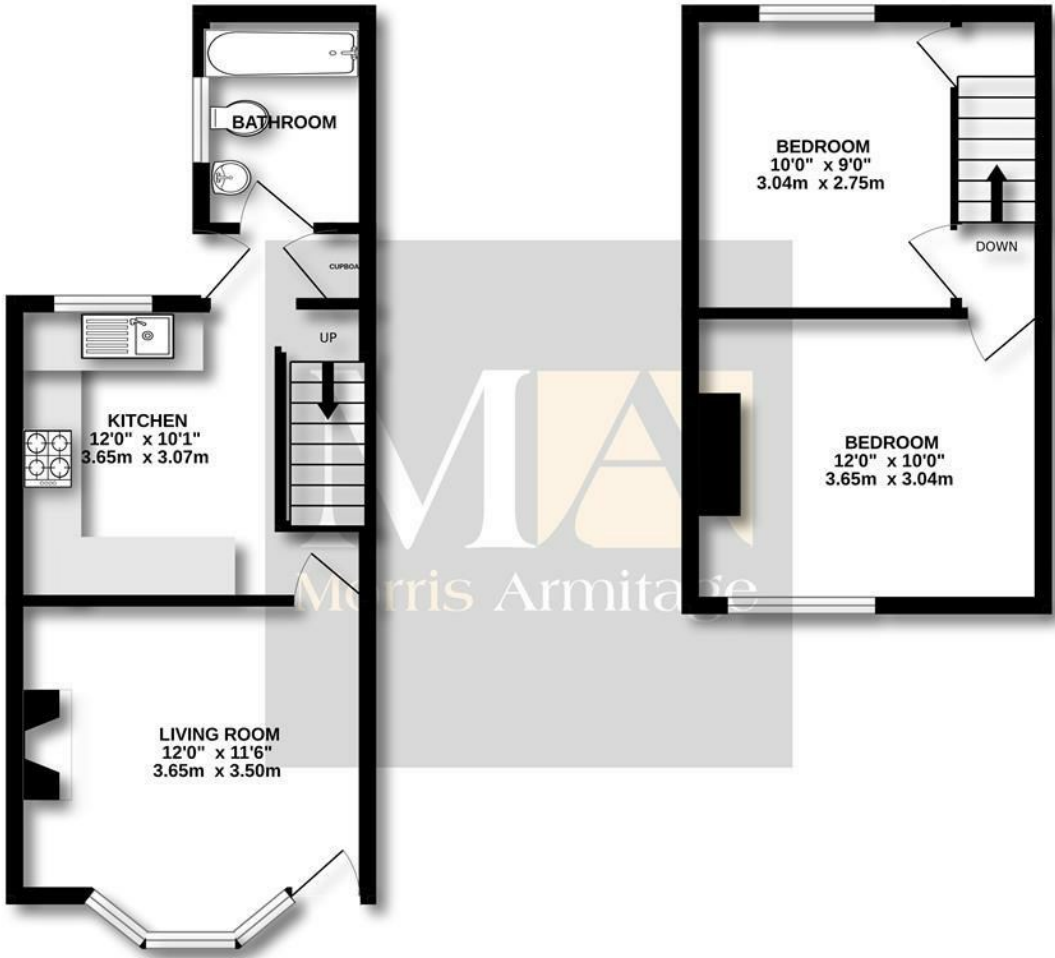

Whilst every attempt has been made to ensure the accuracy of the floorplan contained here, measurements of doors, windows, rooms and any other items are approximate and no responsibility is taken for any error, omission or mis-statement. This plan is for illustrative purposes only and should be used as such by any prospective purchaser. The services, systems and appliances shown have not been tested and no guarantee as to their operability or efficiency can be given.  
Made with Metropix ©2025

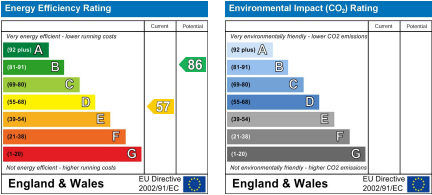
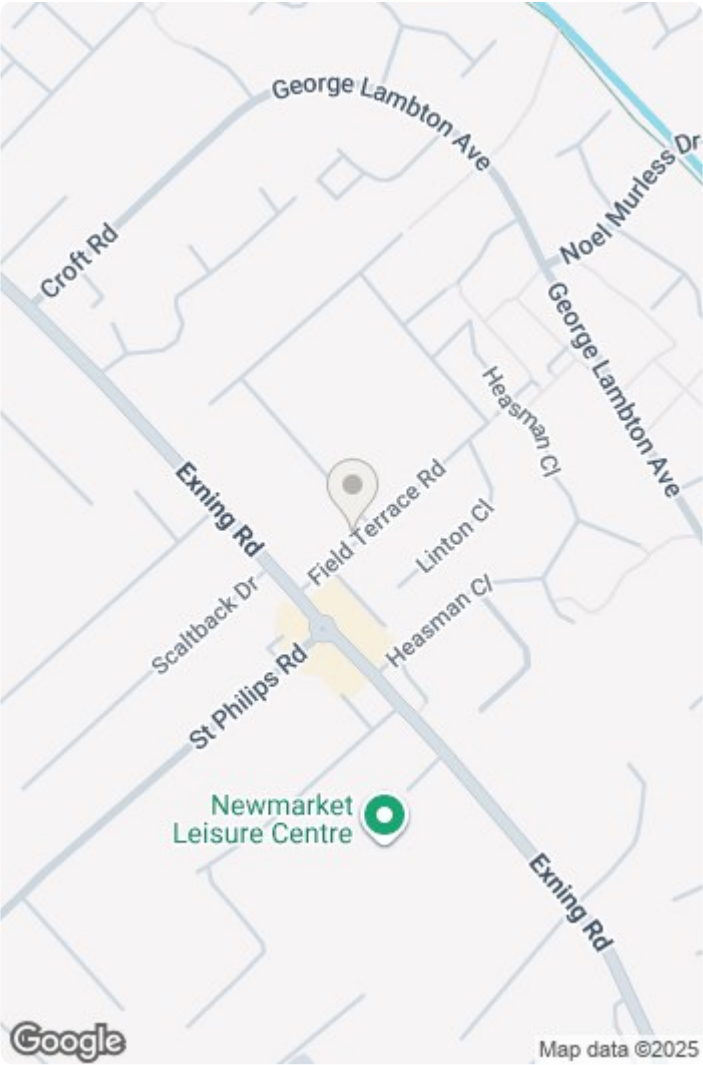

This document and any marketing relating to the property has been prepared in good faith to give a fair overall view of the property and must not be relied upon as statements or representations of fact. It is suggested that undertake enquiries by inspections, survey or other investigation to ascertain the viability of any purchase. Any areas, measurements or distances referred to are given as a guide only and are not precise and no liability can be accepted for errors arising from them. Photographs are not necessarily comprehensive nor current; no assumption should be made that any contents shown are included in the sale. Morris Armitage have not tested any services or equipment and nothing in these particulars should be deemed to be a statement that they are in good working order nor that the property is in good structural condition.



